

EXCEPT AS OTHERWISE PROVIDED BY CONTRACT, THIS DRAWING AND SPECIFICATIONS SHALL NOT BE REPRODUCED, COPIED OR USED AS THE BASIS FOR MANUFACTURE OR SALE OF MATTER DEPICTED HEREIN WITHOUT THE EXPRESSED WRITTEN PERMISSION OF THE CLAUDE LAVAL CORPORATION, OR ITS ASSIGNEES.

NOTES:

1. INLET & OUTLET FLANGES ARE 3" 150# RF PER ANSI B16.5 REQUIRING 8X  $\phi$  5/8" BOLTS (BOLTS AND GASKETS NOT INCLUDED).
2. MAXIMUM PRESSURE: 100 psi (6.9 bar).
3. MAXIMUM TEMPERATURE: 400°F (204°C).
4. PRESSURE LOSS: 3-12 psi (.2-.8 bar) AT RATED FLOW.
5. RATED FLOW: 165-280 gpm (38-64 m<sup>3</sup>/hr).
6. APPROXIMATE DRY WEIGHT: 236 lbs (107 kg).
7. FINISH: GLASSBLAST (EXTERIOR ONLY).
8. GASKETS: SPIRAL WOUND, 304 SS W/PTFE FILLER.
9. INLET & OUTLET PRESSURE GAUGE PORTS TO BE SUPPLIED ON CONNECTING PIPING BY END USER (CARBON STEEL ONLY).

THIS DRAWING HAS BEEN GENERATED AND IS MAINTAINED BY A CAD SYSTEM. CHANGES SHALL ONLY BE INCORPORATED AS DIRECTED BY AN APPROVED ENGINEERING CHANGE ORDER (ECO). PAPER COPIES ARE UNCONTROLLED.

REVISIONS				
ZONE	REV.	DESCRIPTION	DATE	APPROVED

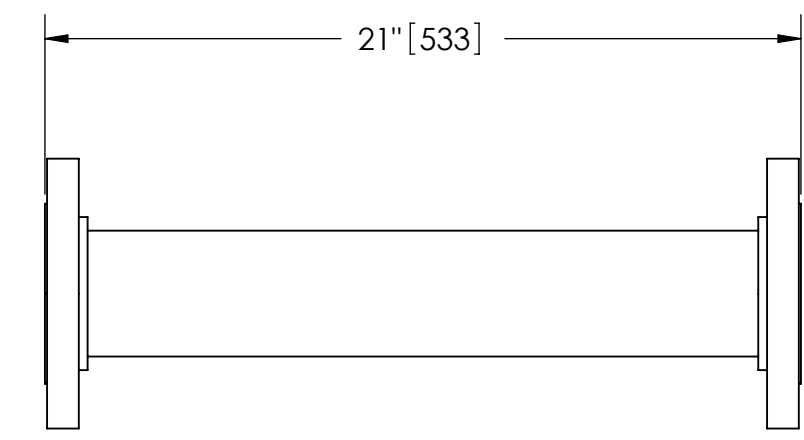
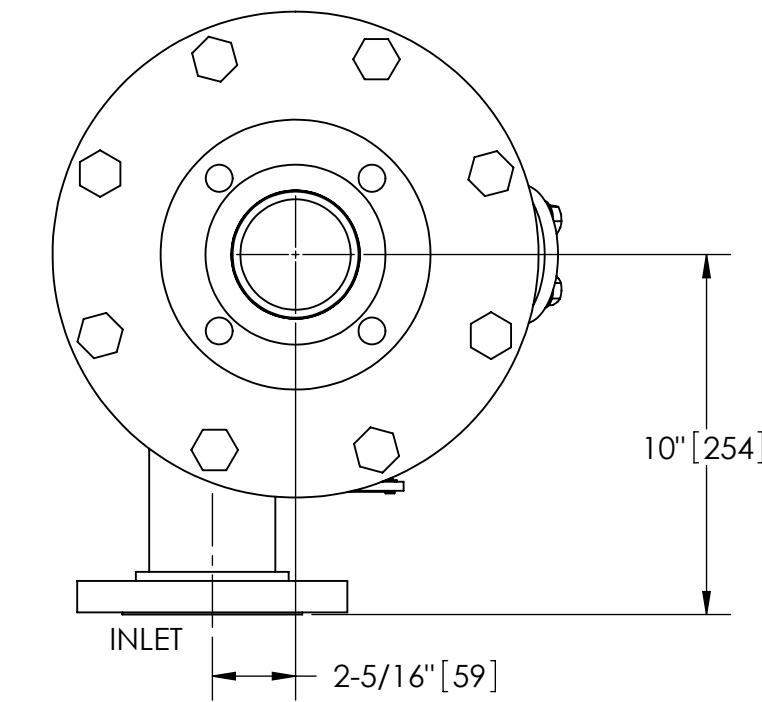
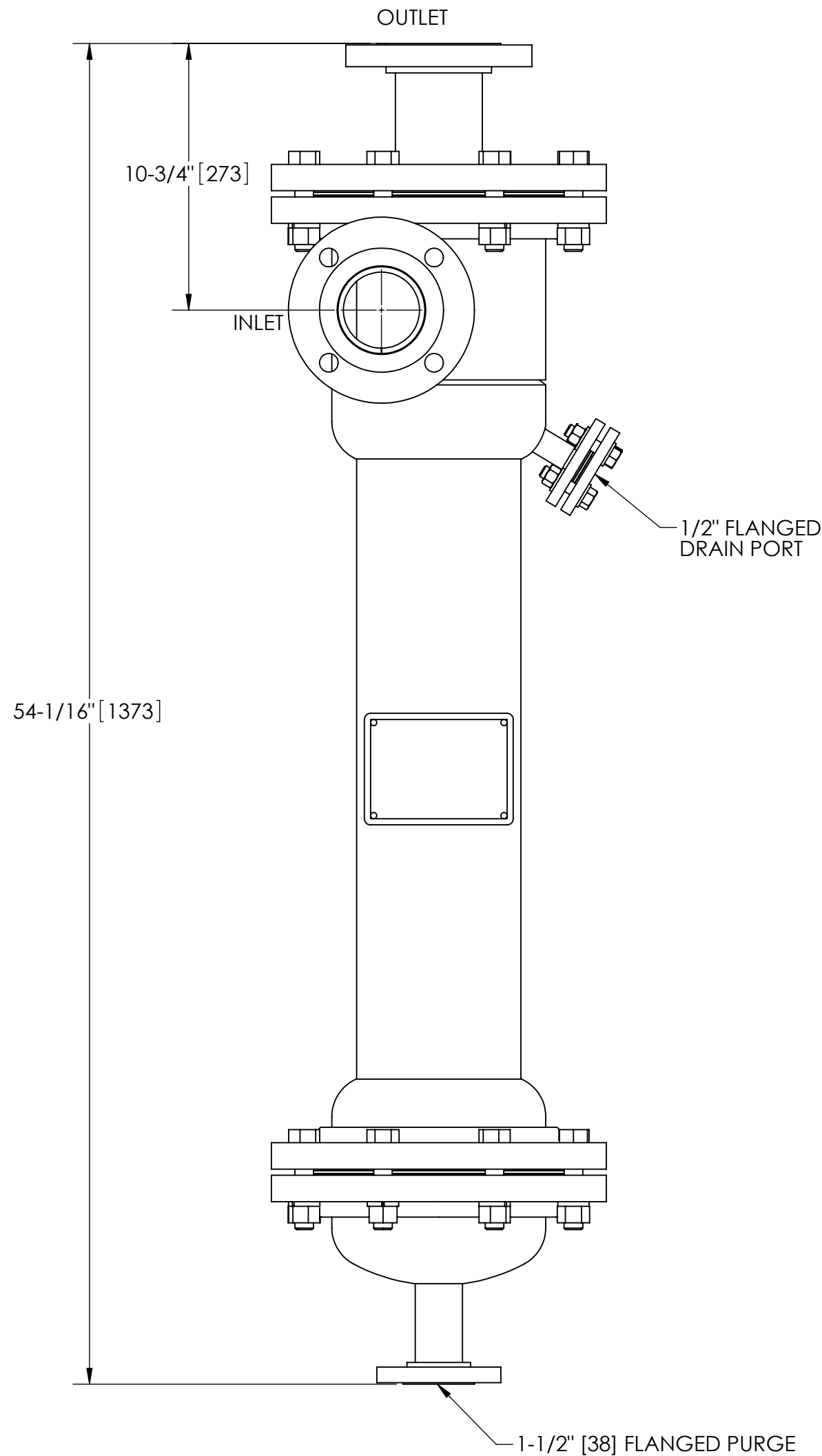

**FLANGED SPOOL**  
 MONDEL FS-03/S4 (AVAILABLE SEPARATELY)  
 REQUIRED FOR REMOVAL OF TOP ASSEMBLY

**SUBMITTAL DRAWING**

This drawing is submitted for spatial consideration only. Do not pre-plumb to these dimensions.

UNLESS OTHERWISE SPECIFIED: DIMENSIONS ARE IN: INCHES [mm] TOLERANCES ARE:		ENGINEERED FOR: <b>304L SS</b>		<b>LAKOS</b> CLAUDE LAVAL CORP. FRESNO, CALIFORNIA 93727 WWW.LAKOS.COM		LAKOS UNDERGROUND SURVEYS	
FRACTIONS $\pm 1/4"$	DECIMALS .XX $\pm .01$ .XXX $\pm .005$ .XXXX $\pm .0005$	ANGLES $\pm 1/4^\circ$	APPROVALS	DATE	TITLE <b>CSX-0165-HV/S4, SEPARATOR</b> 165 - 280gpm, 304L SS		
DO NOT SCALE DRAWING			DRAWN <b>JBI</b>	2/23/07	SIZE <b>C</b>		
MATERIAL TYPE 304L STAINLESS STEEL			ENGR <b>DLW</b>	2/27/07	MODEL NO.	DWG NO. <b>118182</b>	REV. <b>B</b>
FINISH GLASSBLAST			MFG -	-	SCALE <b>3:16</b>	EST. WT. 240 lb	SHEET 1 OF 1
			WORK ORDER	QTY.			

DWG NO. 118182  
 SHEET 1  
 REV. B