

EXCEPT AS OTHERWISE PROVIDED BY CONTRACT, THIS DRAWING AND SPECIFICATIONS SHALL NOT BE REPRODUCED, COPIED OR USED AS THE BASIS FOR MANUFACTURE OR SALE OF MATTER DEPICTED HEREIN WITHOUT THE EXPRESSED WRITTEN PERMISSION OF THE CLAUDE LAVAL CORPORATION, OR ITS ASSIGNEES.

THIS DRAWING HAS BEEN GENERATED AND IS MAINTAINED BY A CAD SYSTEM. CHANGES SHALL ONLY BE INCORPORATED AS DIRECTED BY AN APPROVED ENGINEERING CHANGE ORDER (ECO). PAPER COPIES ARE UNCONTROLLED.

REVISION HISTORY				
ZONE	REV	DESCRIPTION	DATE	APPROVED

NOTES:

1. INLET & OUTLET FLANGES ARE 1" 150# RF PER ANSI B16.5 REQUIRING 4X  $\phi$  1/2" BOLTS (BOLTS AND GASKETS NOT INCLUDED).
2. MAXIMUM PRESSURE: 100 psi (6.89 bar).
3. MAXIMUM TEMPERATURE: 400°F (204°C).
4. PRESSURE LOSS: 3-12 psi (.2-.8 bar) AT RATED FLOW.
5. RATED FLOW: 20-40 gpm (5-9 m<sup>3</sup>/hr).
6. APPROXIMATE DRY WEIGHT: 89 lbs (40 kg).
7. FINISH: LAKOS BLUE (EXTERIOR ONLY).
8. THREADED CONNECTIONS SEALED USING TEFLON PASTE SEALANT JOHN CRANE JC-30 OR EQUIVALENT.
9. GASKETS: SPIRAL WOUND, 304 SS W/PDFF FILLER.

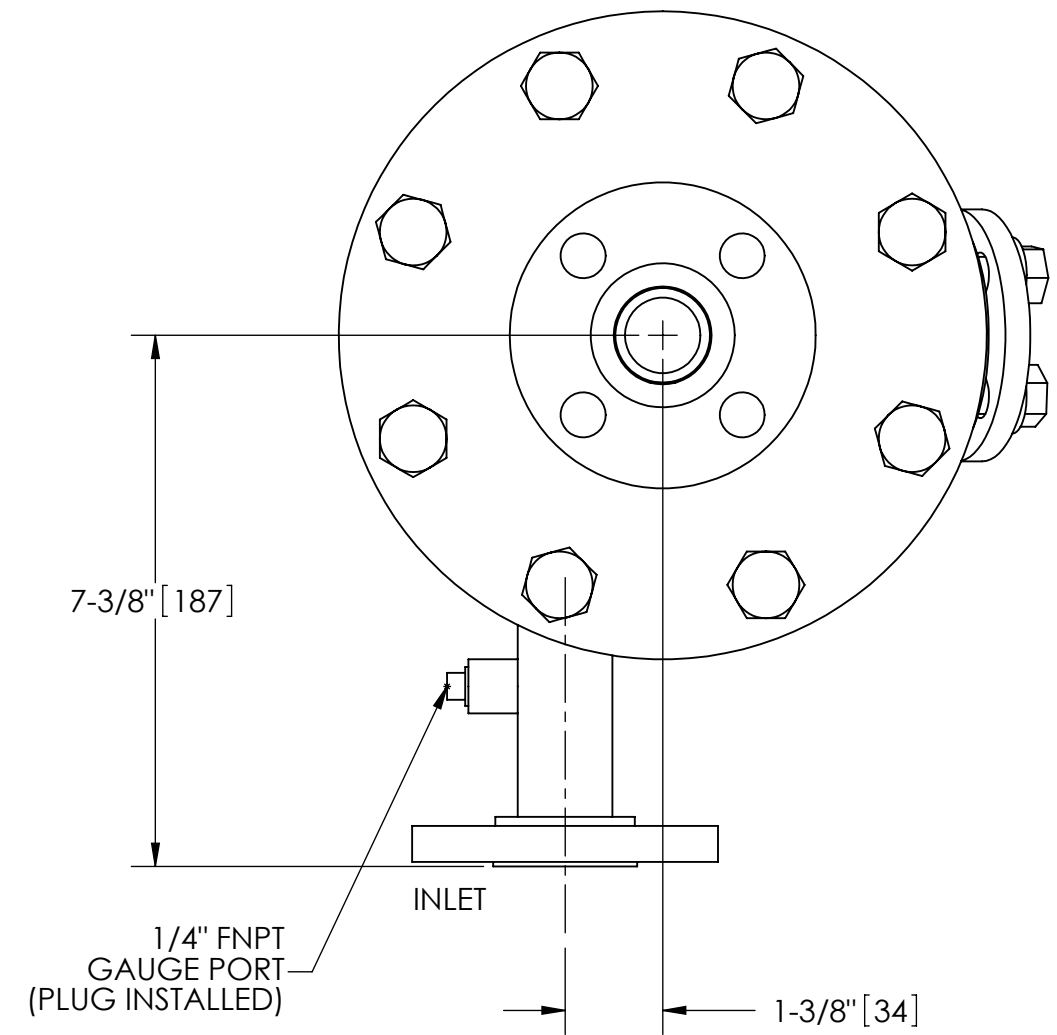
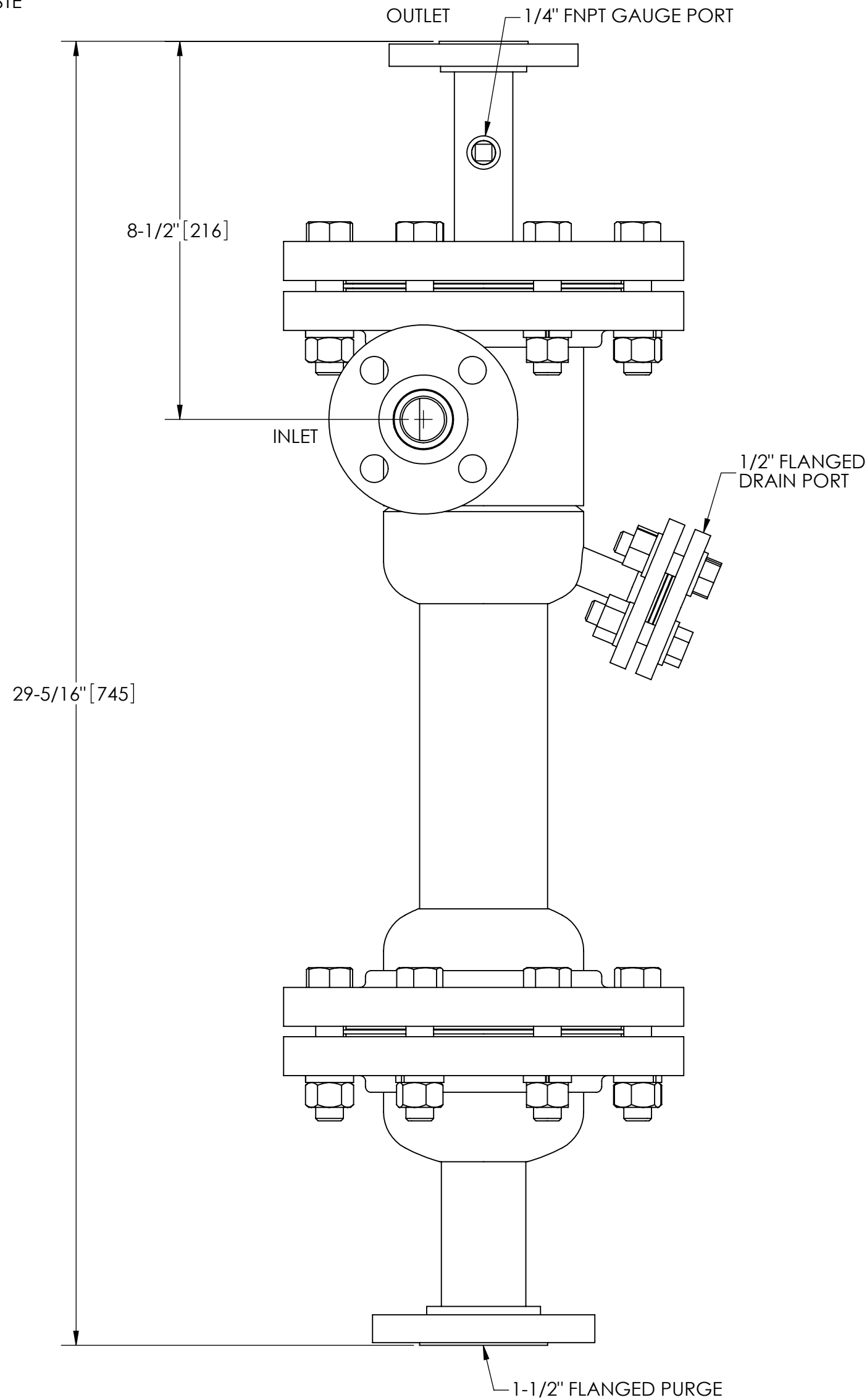

TOP VIEW

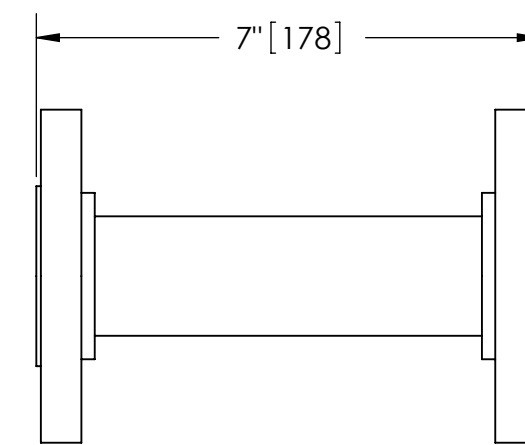

FLANGED SPOOL

MODEL FS-01 (AVAILABLE SEPARATELY)  
REQUIRED FOR REMOVAL OF TOP ASSEMBLY

SUBMITTAL DRAWING

This drawing is submitted for spatial consideration only. Do not pre-plumb to these dimensions.

UNLESS OTHERWISE SPECIFIED: DIMENSIONS ARE IN: INCHES [mm] TOLERANCES ARE:		ENGINEERED FOR: <b>STANDARD</b>		<b>LAKOS</b> CLAUDE LAVAL CORP. FRESNO, CALIFORNIA 93727 WWW.LAKOS.COM		LAVAL UNDERGROUND SURVEYS	
FRACTIONS $\pm 1/4"$	DECIMALS .XX $\pm .01$ .XXX $\pm .005$ .XXXX $\pm .0005$	ANGLES $\pm 1/4^\circ$		APPROVALS	DATE	TITLE CSX-0020-HV, SEPARATOR 20-40 gpm, CARBON STEEL	
DO NOT SCALE DRAWING				DRAWN DLW	9/18/06	SIZE C	
MATERIAL CLASS P-1 MILD CARBON STEEL				ENGR DLW	9/18/06	MODEL NO. 118171	
FINISH LAKOS BLUE				MFG -	-	DWG NO. 118171	
				WORK ORDER	QTY.	REV. B	
						EST. WT. 89 lb	
						SHEET 1 OF 1	

DWG NO. 118171  
SHEET 1  
REV. B