

EXCEPT AS OTHERWISE PROVIDED BY CONTRACT, THIS DRAWING AND SPECIFICATIONS SHALL NOT BE REPRODUCED, COPIED OR USED AS THE BASIS FOR MANUFACTURE OR SALE OF MATTER DEPICTED HEREIN WITHOUT THE EXPRESSED WRITTEN PERMISSION OF THE CLAUDE LAVAL CORPORATION, OR ITS ASSIGNEES.

REVISIONS				
ZONE	REV	DESCRIPTION	DATE	APPROVED

THIS DRAWING HAS BEEN GENERATED AND IS MAINTAINED BY A CAD SYSTEM. CHANGES SHALL ONLY BE INCORPORATED AS DIRECTED BY AN APPROVED ENGINEERING CHANGE ORDER (ECO). PAPER COPIES ARE UNCONTROLLED.

- NOTES:
1. INLET & OUTLET ARE 3/4" MNPT.
 2. MAXIMUM PRESSURE: 150 psi (10.3 bar).
 3. MAXIMUM TEMPERATURE: 180°F (82.2°C).
 4. PRESSURE LOSS: 5.0-12.0 psid AT RATED FLOW.
 5. RATED FLOW: 10-20 gpm (2.5-4.5 m³/hr)
 6. APPROXIMATE DRY WEIGHT: 14 lbs (6.4 Kg).
 7. FINISH: GLASSBLAST (EXTERIOR ONLY).

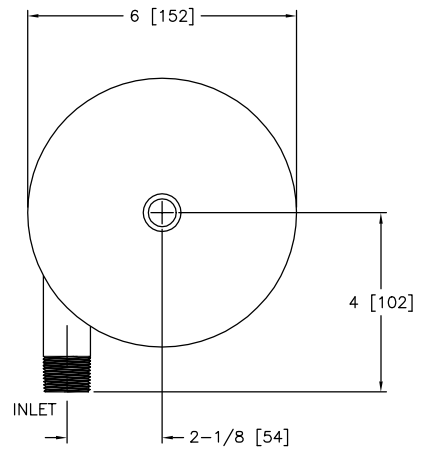
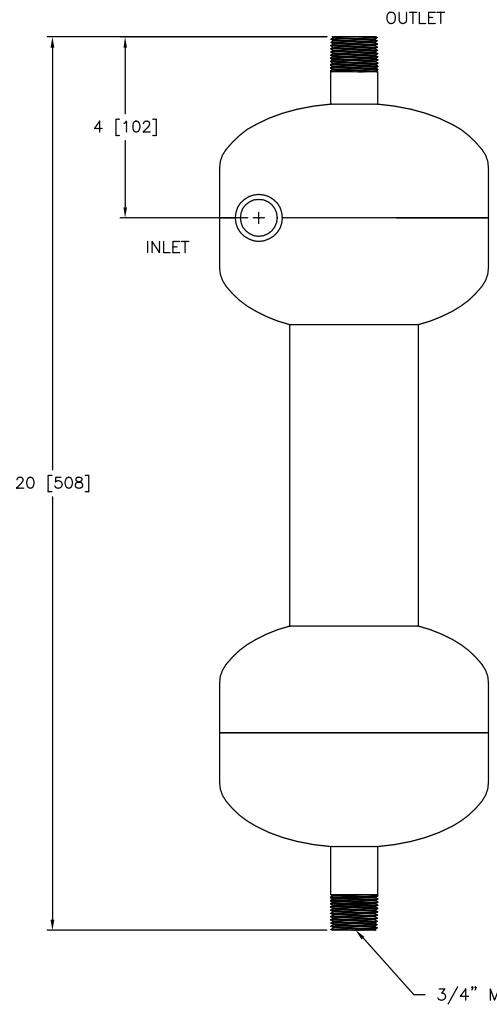

TOP VIEW

SUBMITTAL DRAWING

This drawing is submitted for spatial consideration only. Do not pre-plumb to these dimensions.

<small>UNLESS OTHERWISE SPECIFIED, DIMENSIONS ARE IN INCHES (IPS) TOLERANCES ARE: FRACTIONS DECIMALS MILLIS ±1/4 .005 ±.005 DO NOT SCALE DRAWING MATERIAL TYPE 316L STAINLESS STEEL FINISH GLASS BLAST</small>	ENGINEERED FOR: STANDARD	LAKOS CLAUDE LAVAL CORP. 1365 N. CLOVIS AVE. FRESNO, CALIFORNIA 93727		
	APPROVALS	DATE	TITLE	
	DRAWN GERALD	6/27/97	IL-0075-S, SEPARATOR, 3/4" NPT INLINE, SS 316L	
	REVIEWED			
	ENGR	SIZE C	MODEL NO.	REV.
WORK ORDER	QTY.	SCALE 1/2	DWG NO. 100291	SHEET 1 OF 1

DWG NO. 100291
 SHEET 1 OF 1