

EXCEPT AS OTHERWISE PROVIDED BY CONTRACT, THIS DRAWING AND SPECIFICATIONS SHALL NOT BE REPRODUCED, COPIED OR USED AS THE BASIS FOR MANUFACTURE OR SALE OF MATTER DEPICTED HEREIN WITHOUT THE EXPRESSED WRITTEN PERMISSION OF THE CLAUDE LAVAL CORPORATION, OR ITS ASSIGNEES.

| REVISIONS | | | | |
|-----------|-----|-------------|------|----------|
| ZONE | REV | DESCRIPTION | DATE | APPROVED |
| | | | | |

THIS DRAWING HAS BEEN GENERATED AND IS MAINTAINED BY A CAD SYSTEM. CHANGES SHALL ONLY BE INCORPORATED AS DIRECTED BY AN APPROVED ENGINEERING CHANGE ORDER (ECO). PAPER COPIES ARE UNCONTROLLED.

NOTES:

1. INLET AND OUTLET ARE 1" BSP.
2. MAXIMUM PRESSURE: 150 psi (10.3 bar).
3. PRESSURE LOSS: 5.0-12.0 psi AT RATED FLOW.
4. RATED FLOW: 19-32 gpm (4.5-7.5 m³/hr).
5. APPROXIMATE DRY WEIGHT: 25 lbs (11.3 Kg).

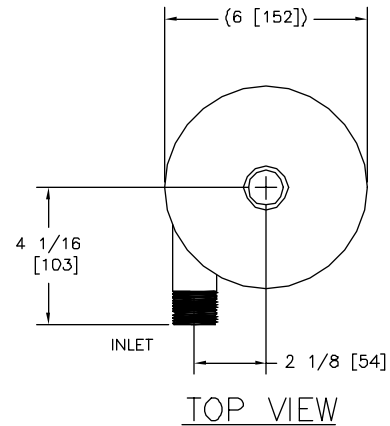
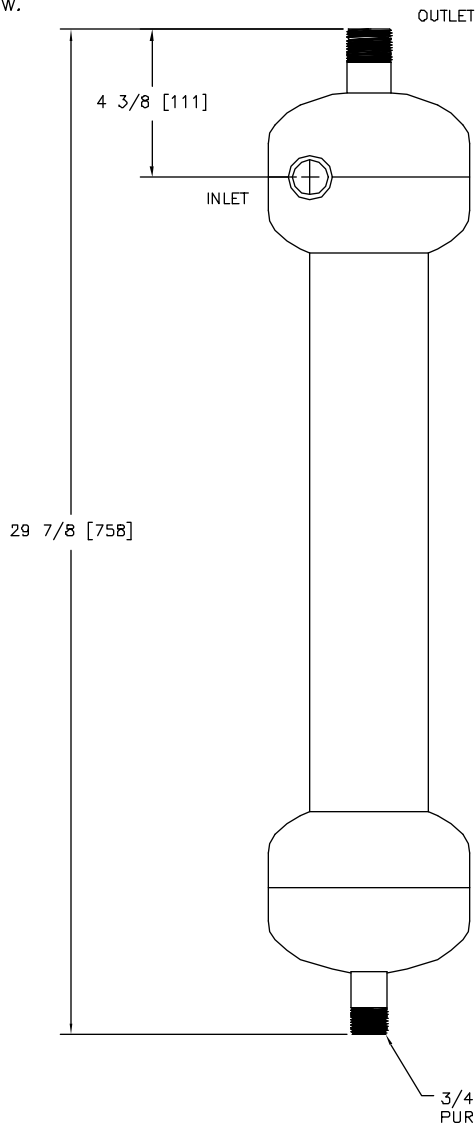

SUBMITTAL DRAWING

This drawing is submitted for spatial consideration only. Do not pre-plumb to these dimensions.

| | | | | | | | |
|--|--|------------------------------------|--|---|--|--|--|
| UNLESS OTHERWISE SPECIFIED: DIMENSIONS ARE IN INCHES (mm) | | DESIGNED FOR: BSP | | LAKOS CLAUDE LAVAL CORP. 1365 N. CLOVIS AVE. FRESNO, CALIFORNIA 93727 | | LAKOS UNCONTROLLED SHEETS | |
| TOLERANCES ARE: FRACTIONS DECIMALS ANGLES ± 1/4" ± .005 ± 1/4" | | APPROVALS | | DRAWN K.F. BITTER 11/1/06 | | TITLE ILS-0100-BSP, SEPARATOR, 1 BSP INLINE, SS 316L | |
| DO NOT SCALE DRAWING | | MATERIAL TP316L STAINLESS STEEL | | FINISH POLISHED | | SCALE 3/8 | |
| WORK ORDER | | QTY | | REV C | | DWC NO. 107506 | |
| | | | | | | SHEET 1 OF 1 | |

4 3 2 1

D

C

B

A

107506

1

1