

EXCEPT AS OTHERWISE PROVIDED BY CONTRACT, THIS DRAWING AND SPECIFICATIONS SHALL NOT BE REPRODUCED, COPIED OR USED AS THE BASIS FOR MANUFACTURE OR SALE OF MATTER DEPICTED HEREIN WITHOUT THE EXPRESSED WRITTEN PERMISSION OF THE CLAUDE LAVAL CORPORATION, OR ITS ASSIGNEES.

THIS DRAWING HAS BEEN GENERATED AND IS MAINTAINED BY A CAD SYSTEM. CHANGES SHALL ONLY BE INCORPORATED AS DIRECTED BY AN APPROVED ENGINEERING CHANGE ORDER (ECO). PAPER COPIES ARE UNCONTROLLED.

REVISIONS				
ZONE	REV	DESCRIPTION	DATE	APPROVED
-	A	ITEM 5 WAS 104279	12/2/99	K.F. BITTER

NOTES:

1. INLET & OUTLET IS 2" BSP.
2. MAXIMUM PRESSURE: 150 psi. (1034 kPa).
3. MAXIMUM TEMPERATURE: 180°F (82.2°C).
4. PRESSURE LOSS: 5.0-12.0 psid AT RATED FLOW.
5. RATED FLOW: 65-108 gpm (14.5-24.5 m<sup>3</sup>/hr).
6. APPROXIMATE DRY WEIGHT: 52 lbs. (27.2 kg.).

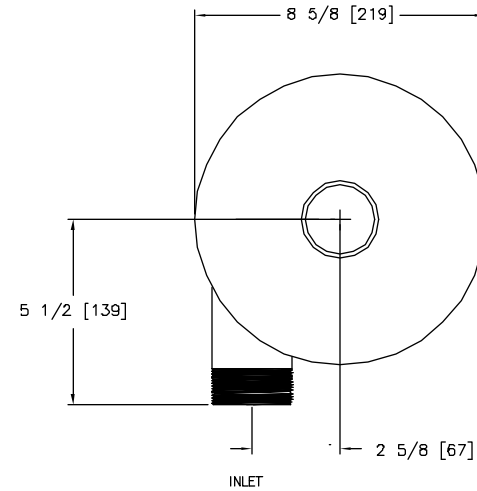
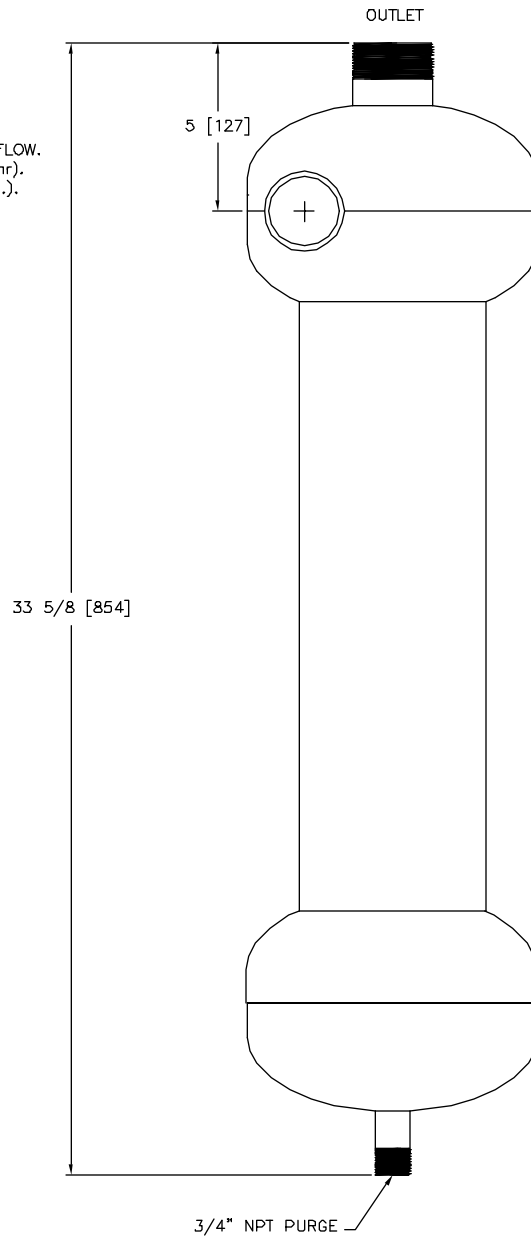

TOP VIEW

**SUBMITTAL DRAWING**

This drawing is submitted for spatial consideration only. Do not pre-plumb to these dimensions.

UNLESS OTHERWISE SPECIFIED: DIMENSIONS ARE IN INCHES (mm) TOLERANCES ARE: FRACTIONS DECIMALS ANGLES ±1/16" ±0.005" ±1/16"		ENGINEERED FOR: <b>STANDARD</b>		CLAUDE LAVAL CORP. 1365 N. CLOVIS AVE. FRESNO, CALIFORNIA 93727		LAVAL UNDERHOLDING SHRETS	
DO NOT SCALE DRAWING		APPROVALS		DATE		TITLE	
MATERIAL TYPE 316L STAINLESS STEEL		DRAWN TOM C./SDF		3/12/98		ILS-0200/BSP, SEPARATOR 2" BSP INLINE, SS 316L	
FINISH GLASSBLAST		ENGR VOID ORDER		3/12/98		DWG NO. 107524	
				SCALE 3/8"		SHEET 1 OF 1	

DWG NO. 107524 BR 1 REV. A