

EXCEPT AS OTHERWISE PROVIDED BY CONTRACT, THIS DRAWING AND SPECIFICATIONS SHALL NOT BE REPRODUCED, COPIED OR USED AS THE BASIS FOR MANUFACTURE OR SALE OF MATTER DEPICTED HEREIN WITHOUT THE EXPRESSED WRITTEN PERMISSION OF THE CLAUDE LAVAL CORPORATION, OR ITS ASSIGNEES.

NOTES:

1. INLET AND OUTLET ARE 2-1/2" BSP.
2. MAXIMUM PRESSURE: 150 psi (1034 kPa).
3. PRESSURE LOSS: 5.0-12.0 psi [34.47-82.74 kPa] AT RATED FLOW.
4. RATED FLOW: 95-155 gpm (21.5-35.0 m³/hr).
5. APPROXIMATE DRY WEIGHT: 55 lbs (24.9 kg).

SUBMITTAL DRAWING

This drawing is submitted for spatial consideration only. Do not pre-plumb to these dimensions.

REVISIONS				
ZONE	REV	DESCRIPTION	DATE	APPROVED

THIS DRAWING HAS BEEN GENERATED AND IS MAINTAINED BY A CAD SYSTEM. CHANGES SHALL ONLY BE INCORPORATED AS DIRECTED BY AN APPROVED ENGINEERING CHANGE ORDER (ECO). PAPER COPIES ARE UNCONTROLLED.

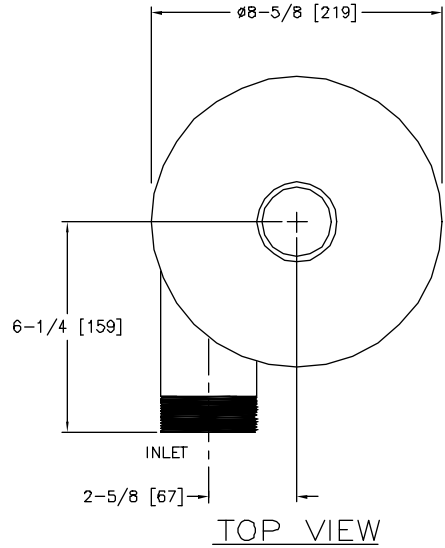
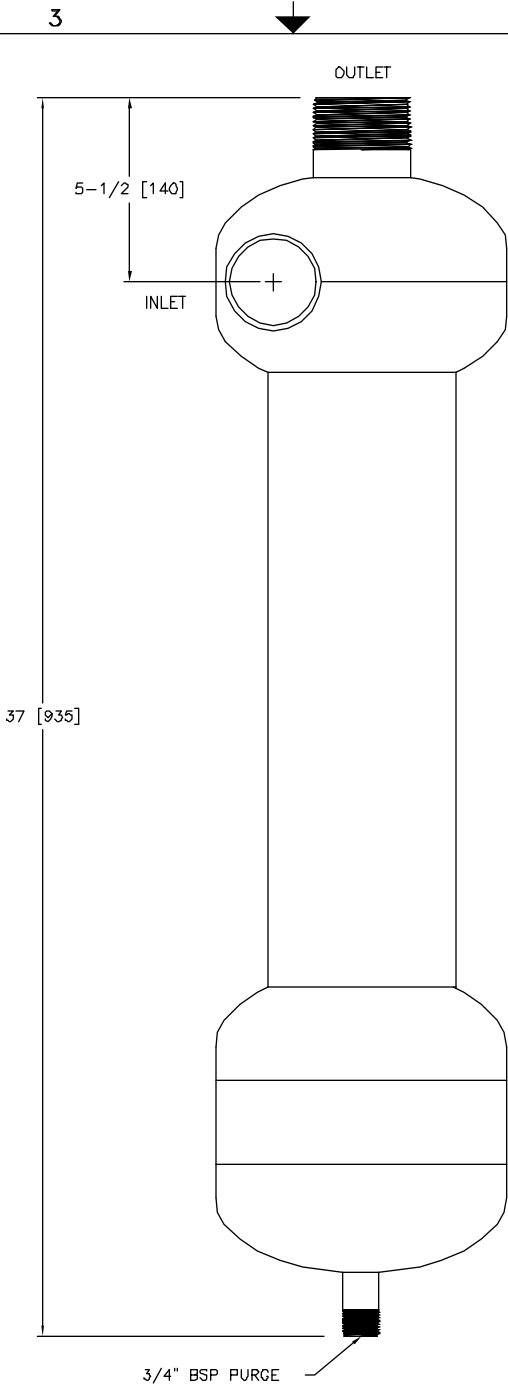

UNLESS OTHERWISE SPECIFIED: DIMENSIONS ARE IN INCHES (mm)		DESIGNED FOR: STANDARD		LAKOS CLAUDE LAVAL CORP. 1365 N. CLOVIS AVE. FRESNO, CALIFORNIA 93727	
TOLERANCES ARE: FRACTIONS DECIMALS ANGLES ±1/4 .005 ±.01 ±1/4		APPROVALS	DATE	LAVL UNDERWRITING SURVEY	
DO NOT SCALE DRAWING		DRAWN	6/06/98	TITLE	
MATERIAL TYPE 316L STAINLESS STEEL		REVIEWED		IL-0250-S/BSP, SEPARATOR, 2-1/2" BSP INLINE, SS	
FINISH	GLASS-BLAST	ENGR		SIZE	MODEL NO.
WORK ORDER		QTY.		C	
SCALE 3/8		DWC NO. 107528		REV. 1 OF 1	

DWC NO. 107528 BR 1 REV.