

4

3

2

1

EXCEPT AS OTHERWISE PROVIDED BY CONTRACT, THIS DRAWING AND SPECIFICATIONS SHALL NOT BE REPRODUCED, COPIED OR USED AS THE BASIS FOR MANUFACTURE OR SALE OF MATTER DEPICTED HEREIN WITHOUT THE EXPRESSED WRITTEN PERMISSION OF THE LAKOS CORPORATION, OR ITS ASSIGNEES.

THIS DRAWING HAS BEEN GENERATED AND IS MAINTAINED BY A CAD SYSTEM. CHANGES SHALL ONLY BE INCORPORATED AS DIRECTED BY AN APPROVED ENGINEERING CHANGE ORDER (ECO). PAPER COPIES ARE UNCONTROLLED.

REVISIONS				
ZONE	REV.	DESCRIPTION	DATE	APPROVED

NOTES:

1. INLET IS 4" PIPE (125# ANSI FLANGED).
2. OUTLET IS 4" PIPE (GROOVED).
3. PURGE OUTLET IS 3/4" NPT.
4. MAXIMUM PRESSURE: 150 psi (10.3 bar).
5. MAXIMUM FLUID TEMPERATURE: 140°F (60°C).
6. SPECIFIED FLOWRATE OF 280 gpm (64 m³/hr).
7. FINISH: AS ASSEMBLED.
8. POWER REQUIREMENT: 3/60/460V.
9. NEMA 4X MOTOR STARTER ENCLOSURE WITH SAFETY DISCONNECT AND H.O.A. SWITCH.
10. APPROXIMATE DRY WEIGHT: 641 lbs (291 kg).
11. INLET/OUTLET VALVE KIT, MODEL TCV-0280 RECOMMENDED.
12. MINIMUM PIPE FROM TOWER BASIN TO TC SYSTEM IS 6" PIPE.
13. FLOODED SUCTION REQUIRED.

COMPONENT LIST

- 1 ELECTRICAL CONTROL BOX: 3/60/460V, W/120V TRANSFORMER.
- 2 SEPARATOR: ILB-0350.
- 3 PUMP: 10 HP, CENTRIFUGAL, TEFC, 3500 rpm, 3/60/460V.
- 4 INLET/OUTLET PRESSURE GAUGES: 0-160 psi, GLYCERIN-FILLED.
- 5 PURGE EQUIPMENT: SRV-816.
- 6 DIFFERENTIAL PRESSURE INDICATOR: (AVAILABLE WITH DRY CONTACT MODEL DEC-100. ORDER SEPARATELY).
- 7 BASKET STRAINER.

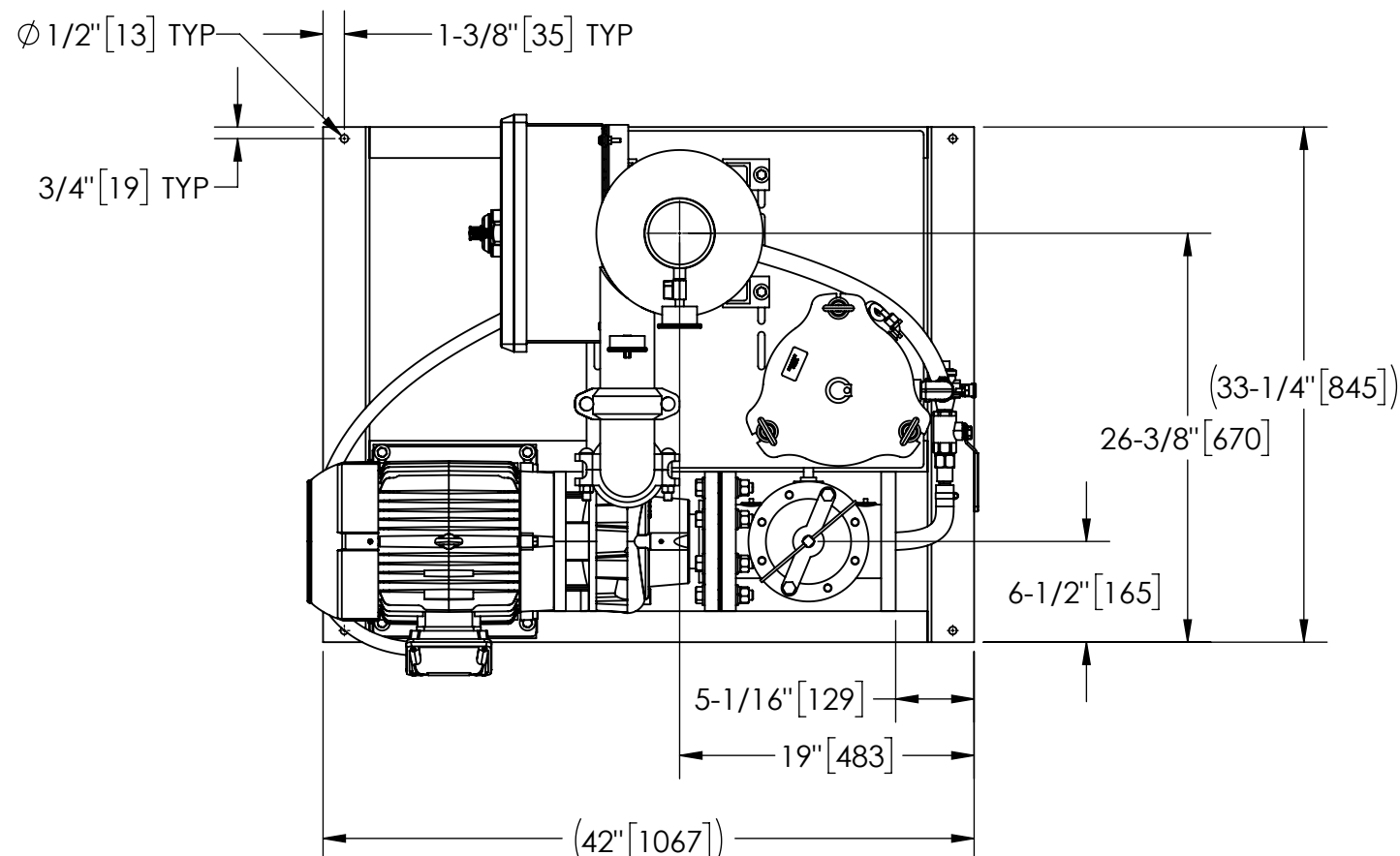

TOP VIEW

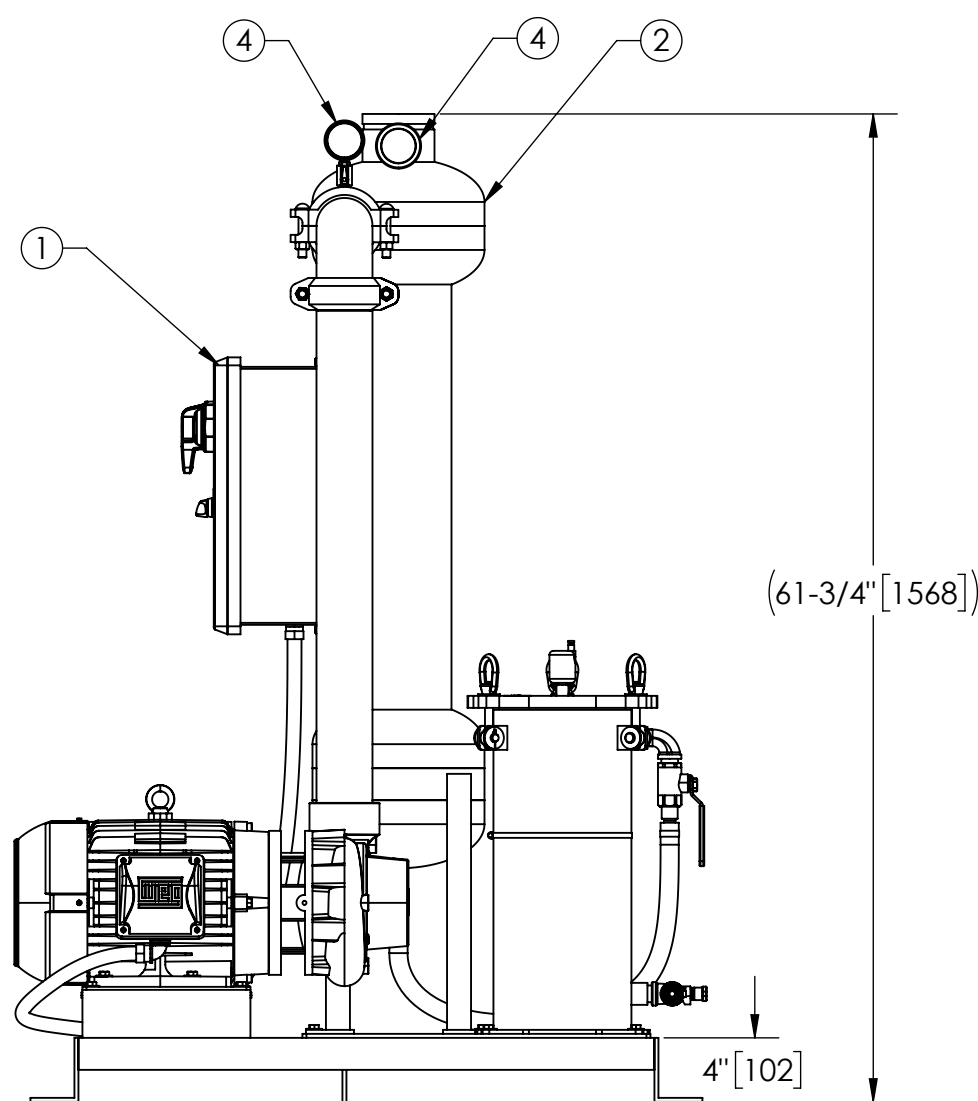

FRONT VIEW
STRAINER HIDDEN

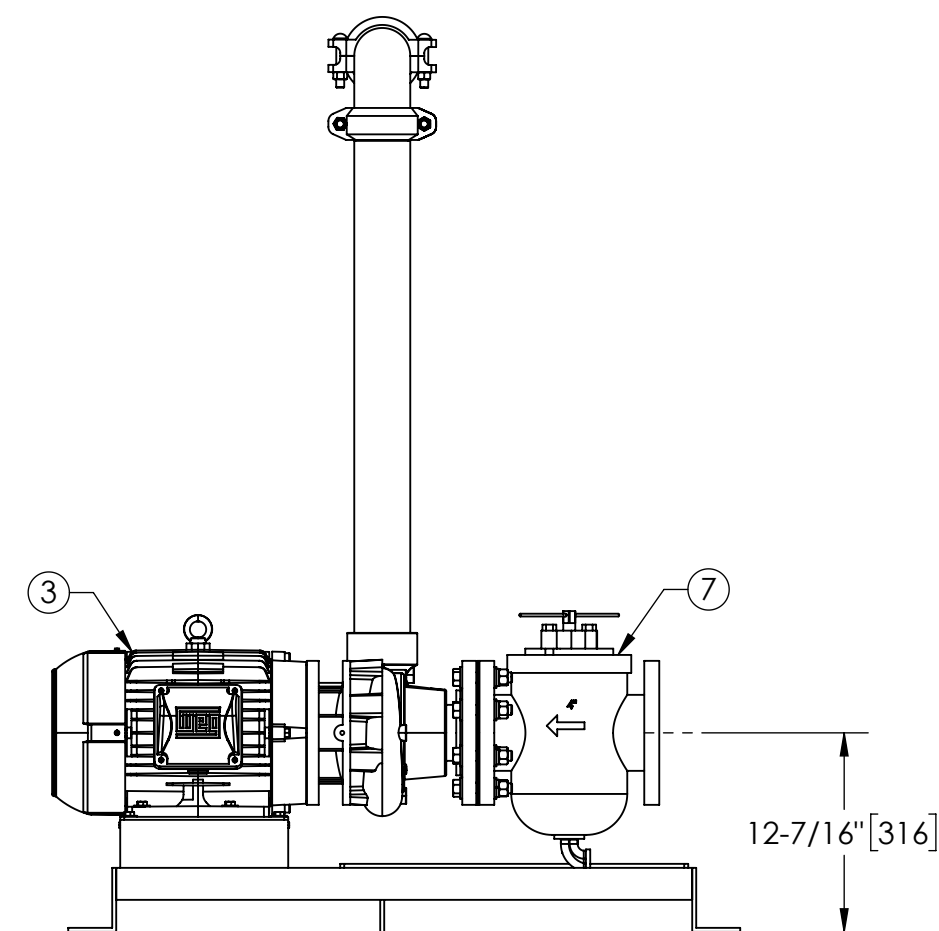

FRONT VIEW
PUMP & STRAINER

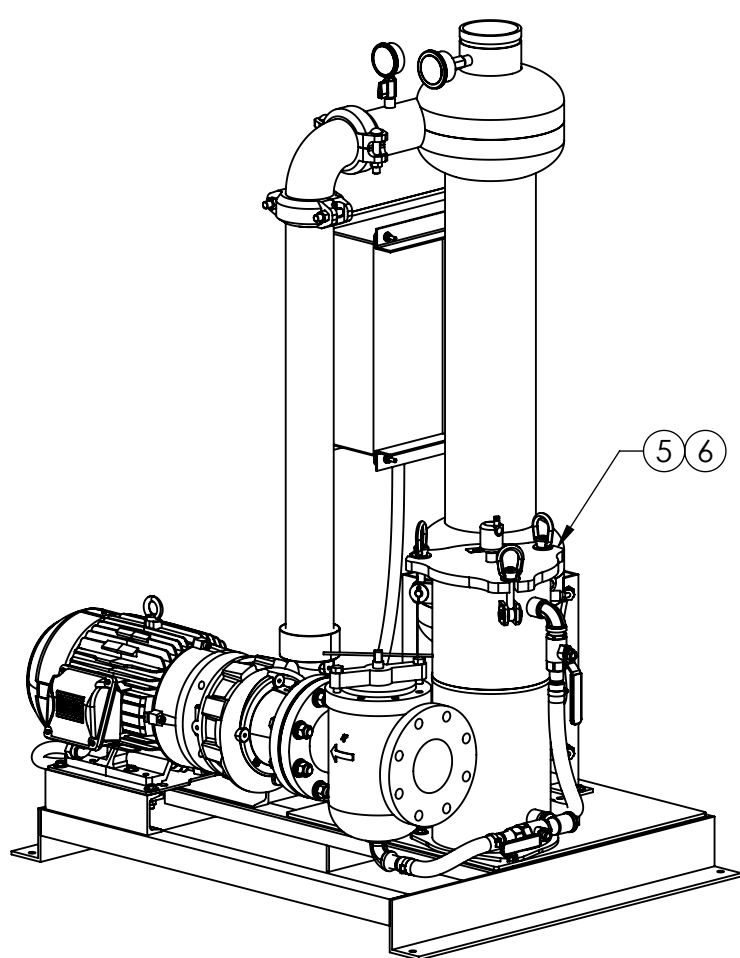

CONCEPTUAL DRAWING

This drawing is submitted for spatial & illustrative purposes only. Do not pre-plumb to these dimensions. Submittal drawings available upon request.

SYSTEM MODELS	
POWER REQUIREMENT	SYSTEM PART NO.
3/60/208V	187691-208
3/60/230V	187691-230
3/60/460V	187691-460
3/60/575V	187691-575
OTHER	SEE FACTORY

UNLESS OTHERWISE SPECIFIED: DIMENSIONS ARE IN: INCHES (mm) TOLERANCES ARE: FRACTIONS DECIMALS ANGLES ± 1" .XX ± .01 ± 1/4" .XXX ± .005 .XXXX ± .0005		ENGINEERED FOR: STANDARD			
DO NOT SCALE DRAWING		APPROVALS	DATE	TITLE	
MATERIAL PER LAKOS SPEC		DRAWN AAM	2/6/24	TCI-0280-SRV/CS SKID, TC SYSTEM. SWEEPER ILB-0350, 3/60/460V	
FINISH AS ASSEMBLED		ENGR -	-	SIZE C	MODEL NO.
WORK ORDER		REVIEW -	-	DWG NO. 187691	REV. A
		SCALE 1:12	EST. WT. 641 lb	SHEET 1 OF 1	

4

3

2

1