

EXCEPT AS OTHERWISE PROVIDED BY CONTRACT, THIS DRAWING AND SPECIFICATIONS SHALL NOT BE REPRODUCED, COPIED OR USED AS THE BASIS FOR MANUFACTURE OR SALE OF MATTER DEPICTED HEREIN WITHOUT THE EXPRESSED WRITTEN PERMISSION OF THE LAKOS CORPORATION, OR ITS ASSIGNEES.

THIS DRAWING HAS BEEN GENERATED AND IS MAINTAINED BY A CAD SYSTEM. CHANGES SHALL ONLY BE INCORPORATED AS DIRECTED BY AN APPROVED ENGINEERING CHANGE ORDER (ECO). PAPER COPIES ARE UNCONTROLLED.

REVISION HISTORY				
ZONE	REV	DESCRIPTION	DATE	APPROVED
	G	UPDATE TO CURRENT STANDARDS	2/17/23	CEE

NOTES:

1. INLET IS 10" PIPE (150# ANSI FLANGED).
2. OUTLET IS 8" PIPE (150# ANSI FLANGED).
3. PURGE OUTLET IS 1-1/2" PIPE.
4. MAXIMUM PRESSURE: 150 psi (10.3 bar).
5. MAXIMUM TEMPERATURE: 100°F (37.8°C).
6. SPECIFIED FLOWRATE OF 1670 gpm (380 m³/hr).
7. FINISH: AS ASSEMBLED.
8. POWER REQUIREMENT: 3/60/460V.
9. APPROXIMATE DRY WEIGHT: 2345 lbs (1064 kg).
10. MINIMUM PIPE FROM TOWER BASIN TO TC SYSTEM IS 12" PIPE.
11. FLOODED SUCTION REQUIRED.

COMPONENT LIST:

- ① ELECTRICAL CONTROL BOX 3/60/460V W/120V TRANSFORMER.
- ② SEPARATOR: HTX-0810-L/FLG.
- ③ PUMP: 25HP END SUCTION CENTRIFUGAL, 3/60/460V.
- ④ INLET/OUTLET PRESSURE GAUGES: 0-160 psi, GLYCERIN-FILLED.
- ⑤ PURGE EQUIPMENT: ABV-15-120.
- ⑥ SKID: CARBON STEEL.

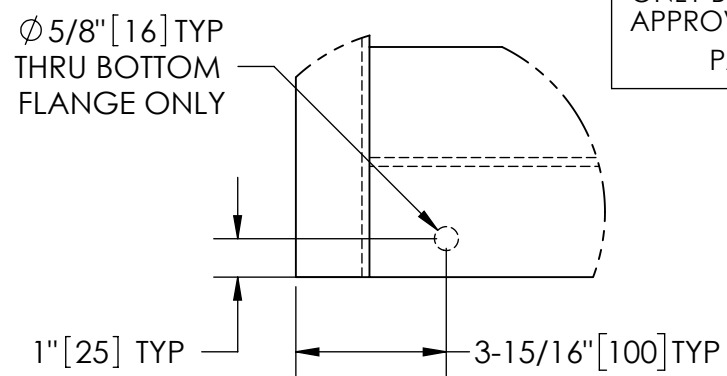

DETAIL A
SCALE 1 : 5

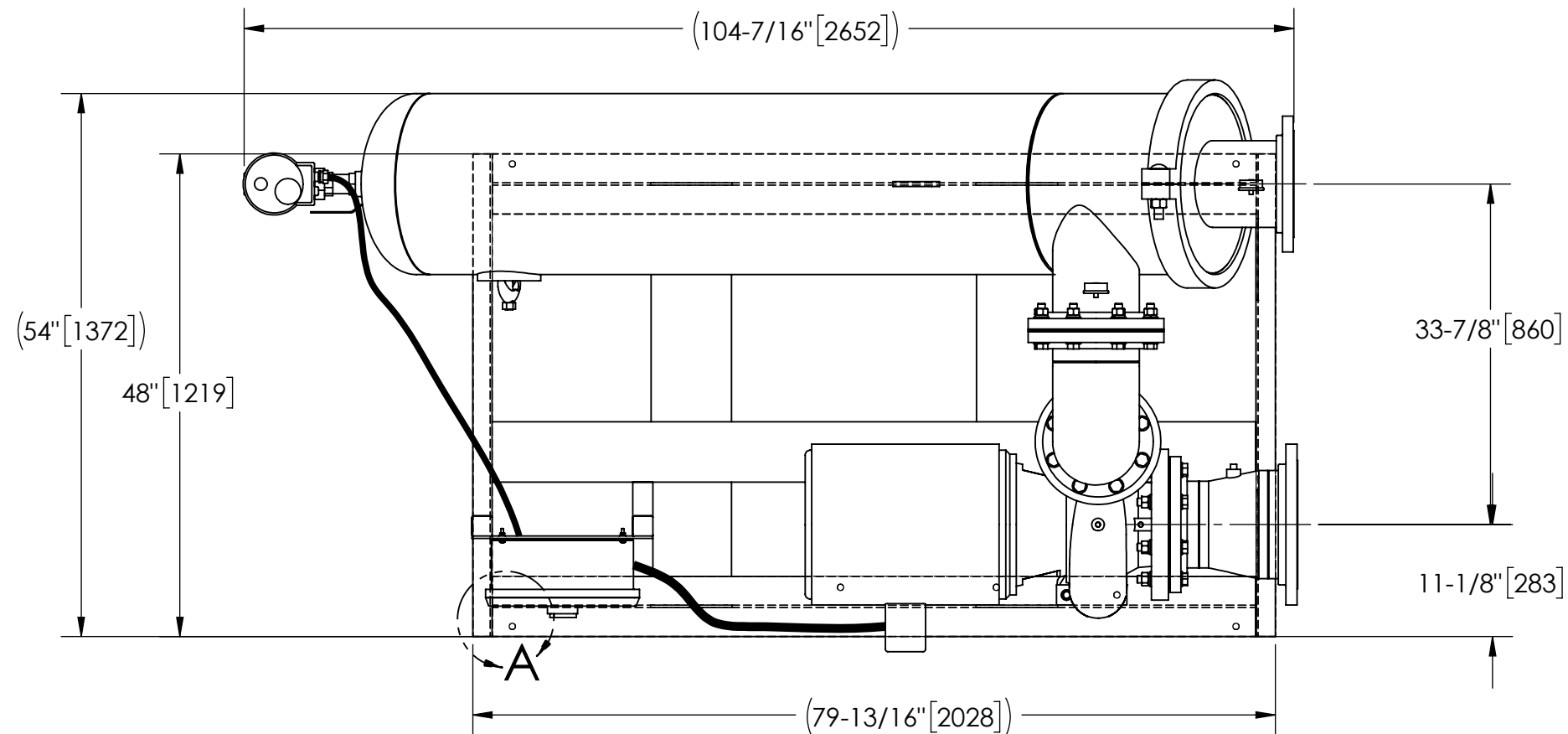

SUBMITTAL DRAWING

This drawing is submitted for spatial consideration only. Do not pre-plumb to these dimensions.

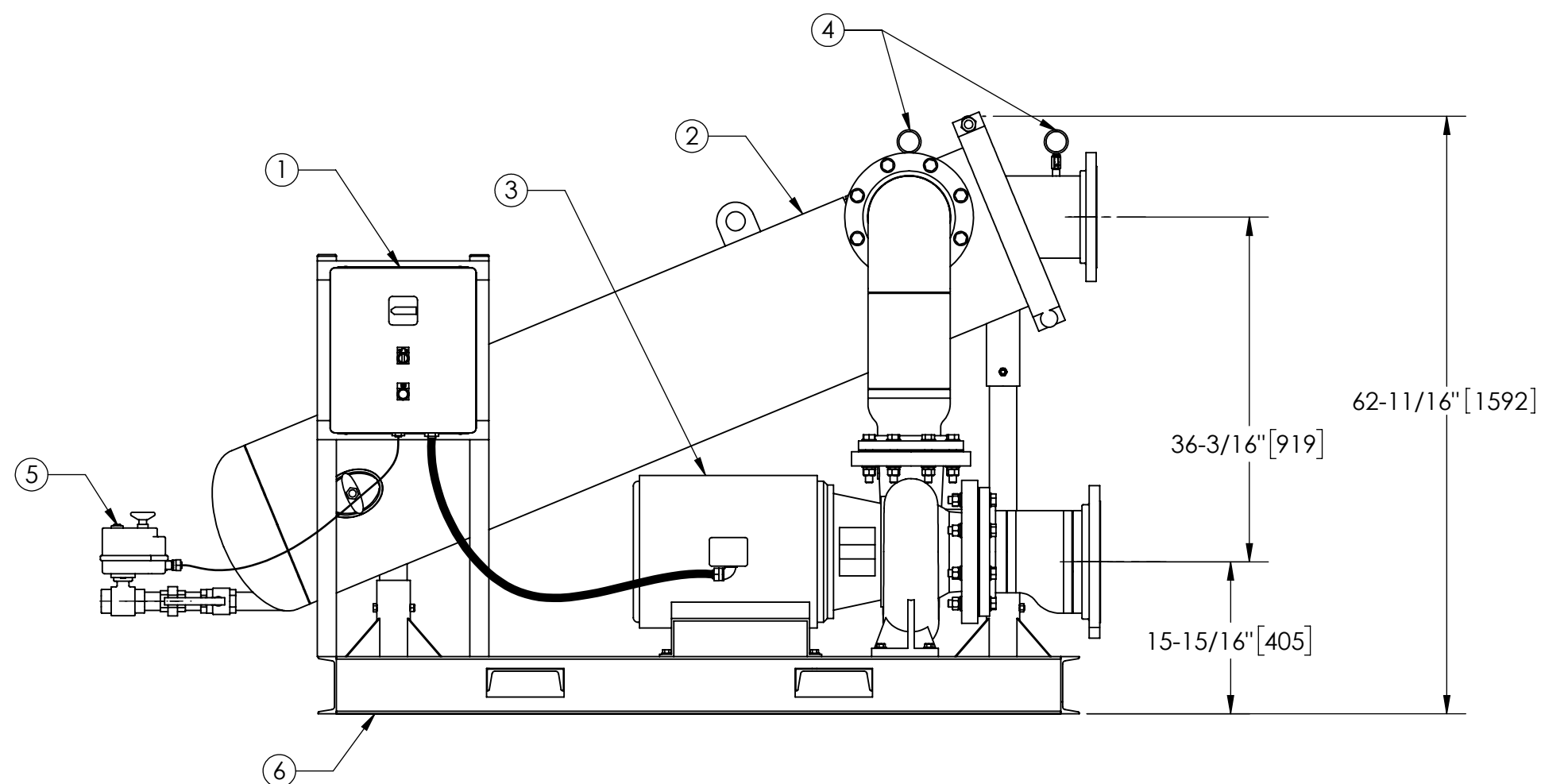
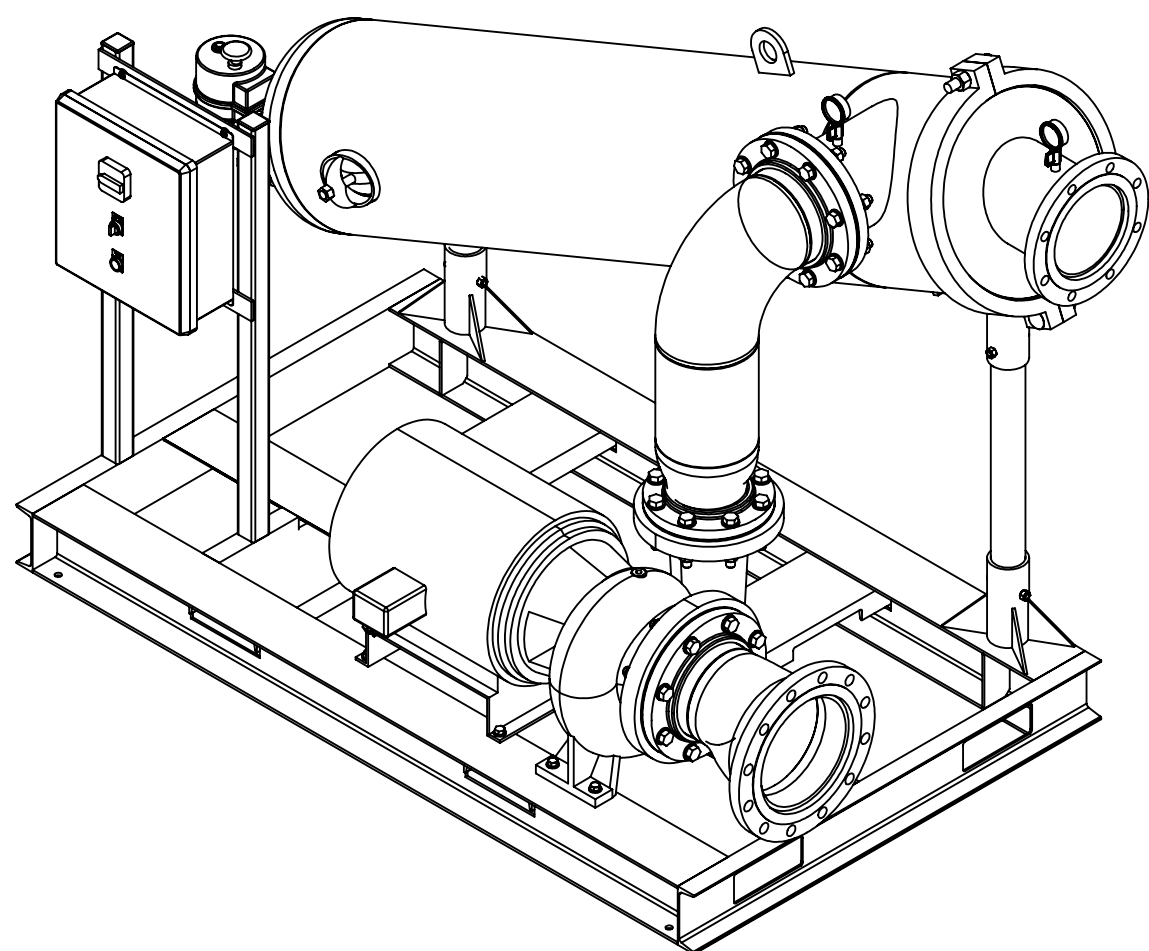

UNLESS OTHERWISE SPECIFIED: DIMENSIONS ARE IN: INCHES (mm) TOLERANCES ARE: FRACTIONS DECIMALS ANGLES ± 1" .XX ± .01 ± 1/4" XXX ± .005 XXXX ± .0005		ENGINEERED FOR: STANDARD			
DO NOT SCALE DRAWING	APPROVALS	DATE	TITLE		
MATERIAL PER LAKOS SPEC	DRAWN ADJ	8/13/07	TBX-1670-ABV/L, TC SYSTEM, SIDESTREAM HTX-0810-L/FLG, 3/60/460V		
FINISH AS ASSEMBLED	ENGR ADJ	8/14/07	SIZE C	MODEL NO.	DWG NO. 128233
	REVIEW -	-	SCALE 1:16	EST. WT. 2345 lb	SHEET 1 OF 1
	WORK ORDER	QTY.			REV. G

DWG. NO. 128233 SHEET 1 REV. G