

EXCEPT AS OTHERWISE PROVIDED BY CONTRACT, THIS DRAWING AND SPECIFICATIONS SHALL NOT BE REPRODUCED, COPIED OR USED AS THE BASIS FOR MANUFACTURE OR SALE OF MATTER DEPICTED HEREIN WITHOUT THE EXPRESSED WRITTEN PERMISSION OF THE CLAUDE LAVAL CORPORATION, OR ITS ASSIGNEES.

THIS DRAWING HAS BEEN GENERATED AND IS MAINTAINED BY A CAD SYSTEM. CHANGES SHALL ONLY BE INCORPORATED AS DIRECTED BY AN APPROVED ENGINEERING CHANGE ORDER (ECO). PAPER COPIES ARE UNCONTROLLED.

REVISIONS				
ECN	REV.	DESCRIPTION	DATE	APPROVED
	C	ADD CENTER OF GRAVITY, UPDATE TO CURRENT STANDARDS	3/24/20	AMF

NOTES:

1. INLET & OUTLET FLANGES ARE 8" 150# RF PER ANSI B16.5, REQUIRING 8X  $\phi$  3/4" BOLTS (BOLTS AND GASKETS NOT INCLUDED).
2. MAXIMUM PRESSURE: 150 psi (10.3 bar).
3. MAXIMUM TEMPERATURE: 180°F (82°C).
4. PRESSURE LOSS: 23-15 psid (.21-1.03 bar) AT RATED FLOW.
5. RATED FLOW: 940-2060 gpm (213-468 m<sup>3</sup>/hr).
6. APPROXIMATE DRY WEIGHT: 1688 lbs (769 kg).
7. FINISH: POWDERCOAT LAKOS MEDIUM GRAY RAL-7005 (EXTERIOR ONLY).
8. CERTIFIED UNDER NSF/ANSI STANDARD NSF 61 & ANNEX G.

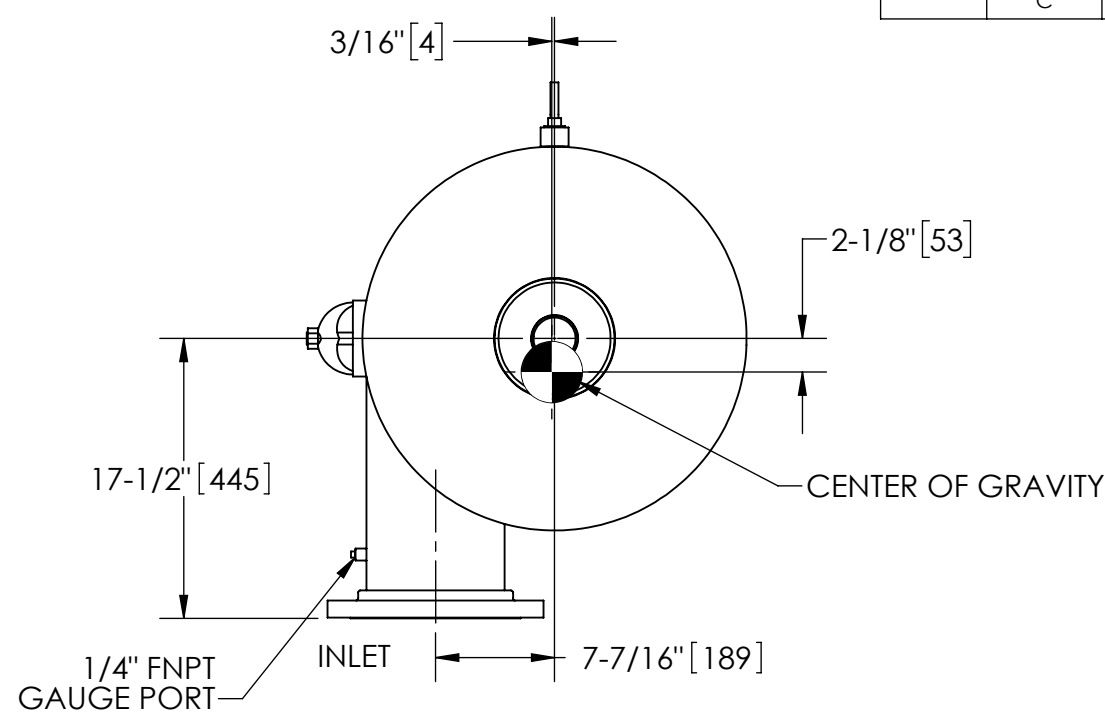

SECTION A-A

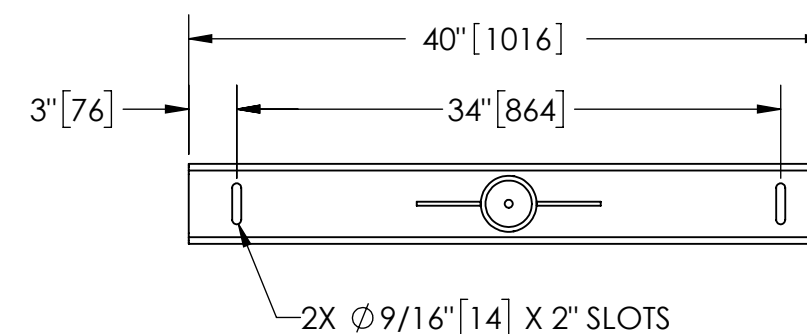

SECTION B-B

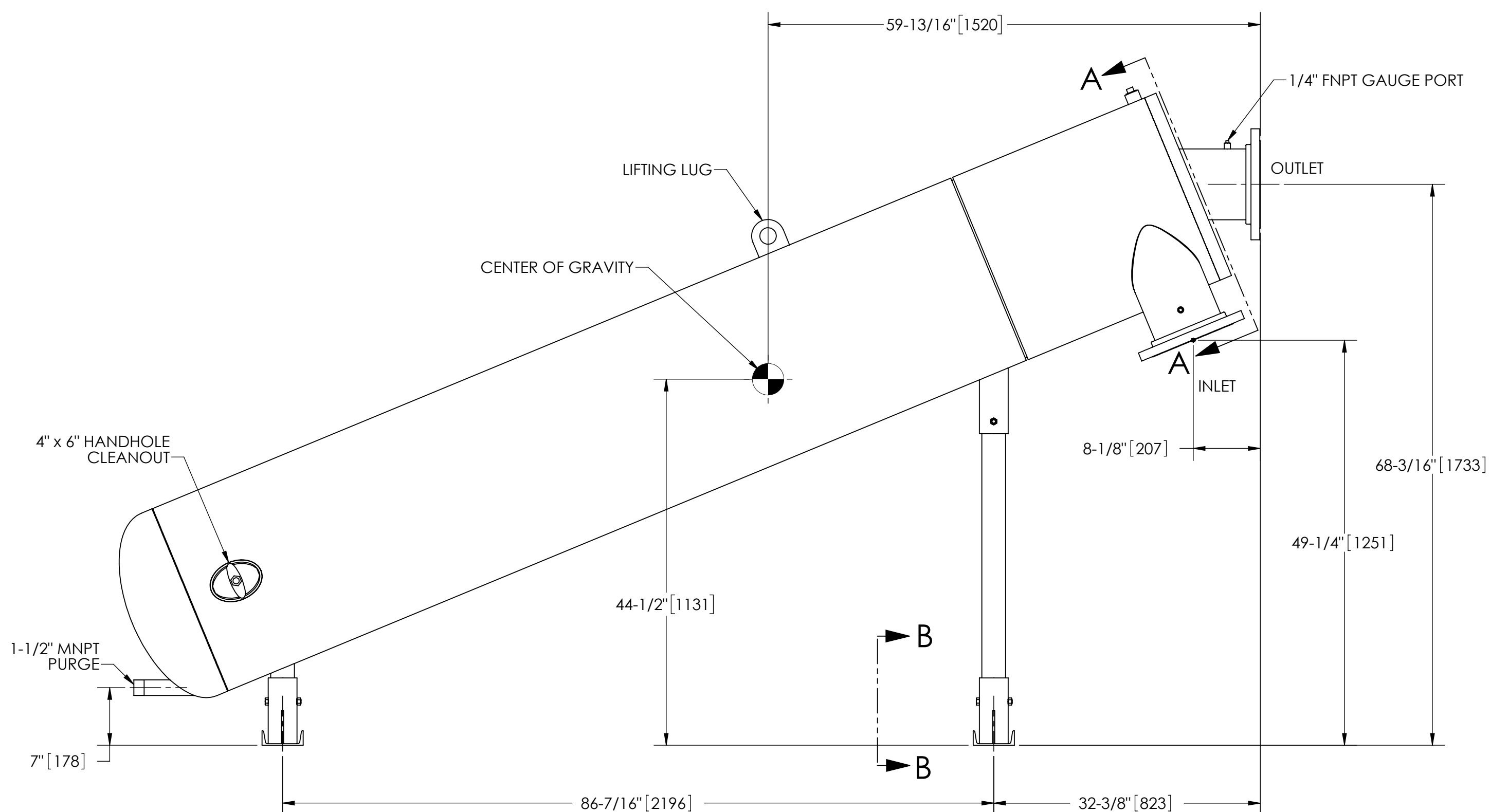

**SUBMITTAL DRAWING**

This drawing is submitted for spatial consideration only. Do not pre-plumb to these dimensions.

UNLESS OTHERWISE SPECIFIED: DIMENSIONS ARE IN: INCHES (mm) TOLERANCES ARE: FRACTIONS DECIMALS ANGLES $\pm 1/2"$ .XX $\pm .01$ $\pm 1/4"$ XXX $\pm .005$ XXXX $\pm .0005$		ENGINEERED FOR: STANDARD			
DO NOT SCALE DRAWING		APPROVALS	DATE	TITLE	
MATERIAL	CLASS P-1 MILD CARBON STEEL	DRAWN	CAG	PWC-1080-L, SEPARATOR, 940-2060 GPM, CARBON STEEL	
FINISH	POWDERCOAT LAKOS MEDIUM GRAY RAL-7005	ENGR	SDF	SIZE	MODEL NO.
WORK ORDER		MFG	-	C	
		WORK ORDER	QTY.	DWG NO.	133381
				EST. WT.	1688 lb
				SHEET	1 OF 1
				SCALE	1:12

DWG NO. 133381 SH 1 REV C