

4

3

2

1

EXCEPT AS OTHERWISE PROVIDED BY CONTRACT, THIS DRAWING AND SPECIFICATIONS SHALL NOT BE REPRODUCED, COPIED OR USED AS THE BASIS FOR MANUFACTURE OR SALE OF MATTER DEPICTED HEREIN WITHOUT THE EXPRESSED WRITTEN PERMISSION OF THE LAKOS CORPORATION, OR ITS ASSIGNEES.

THIS DRAWING HAS BEEN GENERATED AND IS MAINTAINED BY A CAD SYSTEM. CHANGES SHALL ONLY BE INCORPORATED AS DIRECTED BY AN APPROVED ENGINEERING CHANGE ORDER (ECO). PAPER COPIES ARE UNCONTROLLED.

REVISIONS				
ECN	REV.	DESCRIPTION	DATE	APPROVED
	C	RELEASED FOR SUBMITTAL	8/5/2024	FR

NOTES:

1. INLET & OUTLET ARE 1-1/2" MNPT PIPE.
2. MAXIMUM PRESSURE: 100 psi (6.9 bar).
3. MAXIMUM TEMPERATURE: 120°F (49°C).
4. PRESSURE LOSS: 3-12 psid (.2-.8 bar) AT RATED FLOW.
5. RATED FLOW: 45-70 gpm (10.2-15.9 m³/hr).
6. APPROXIMATE DRY WEIGHT: 15 lbs (6 kg).
7. FINISH: POLISH (EXTERIOR ONLY).

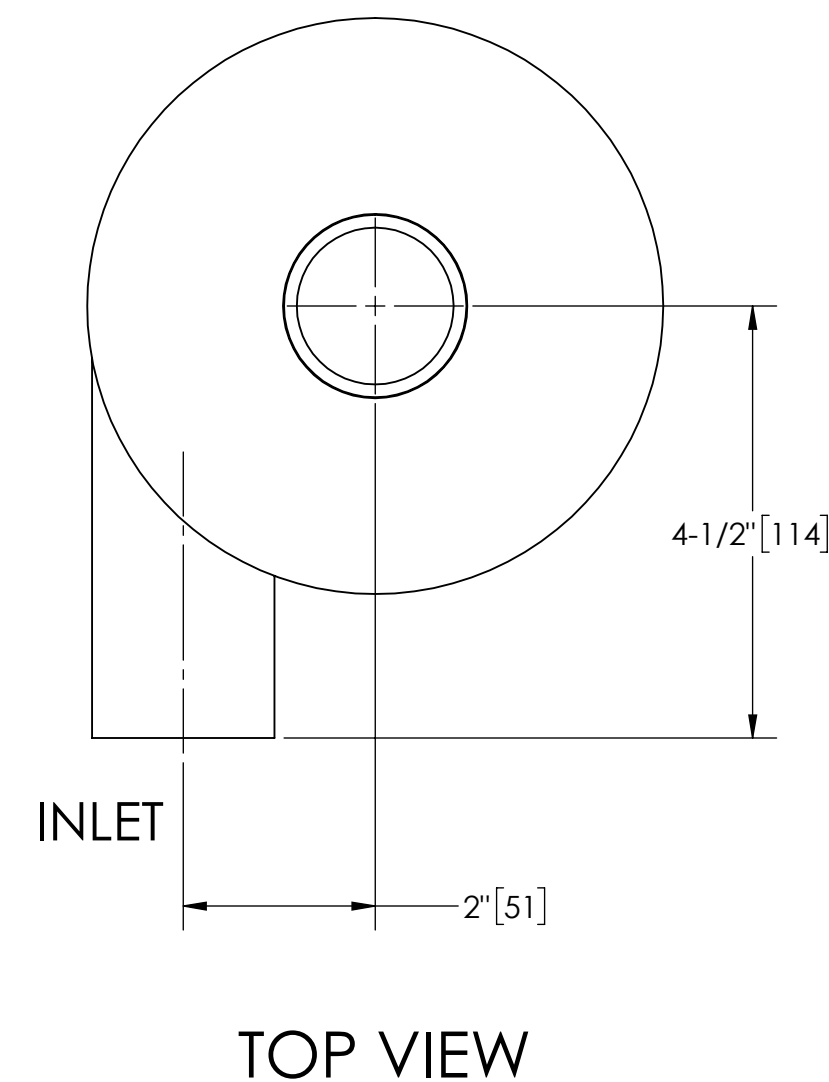
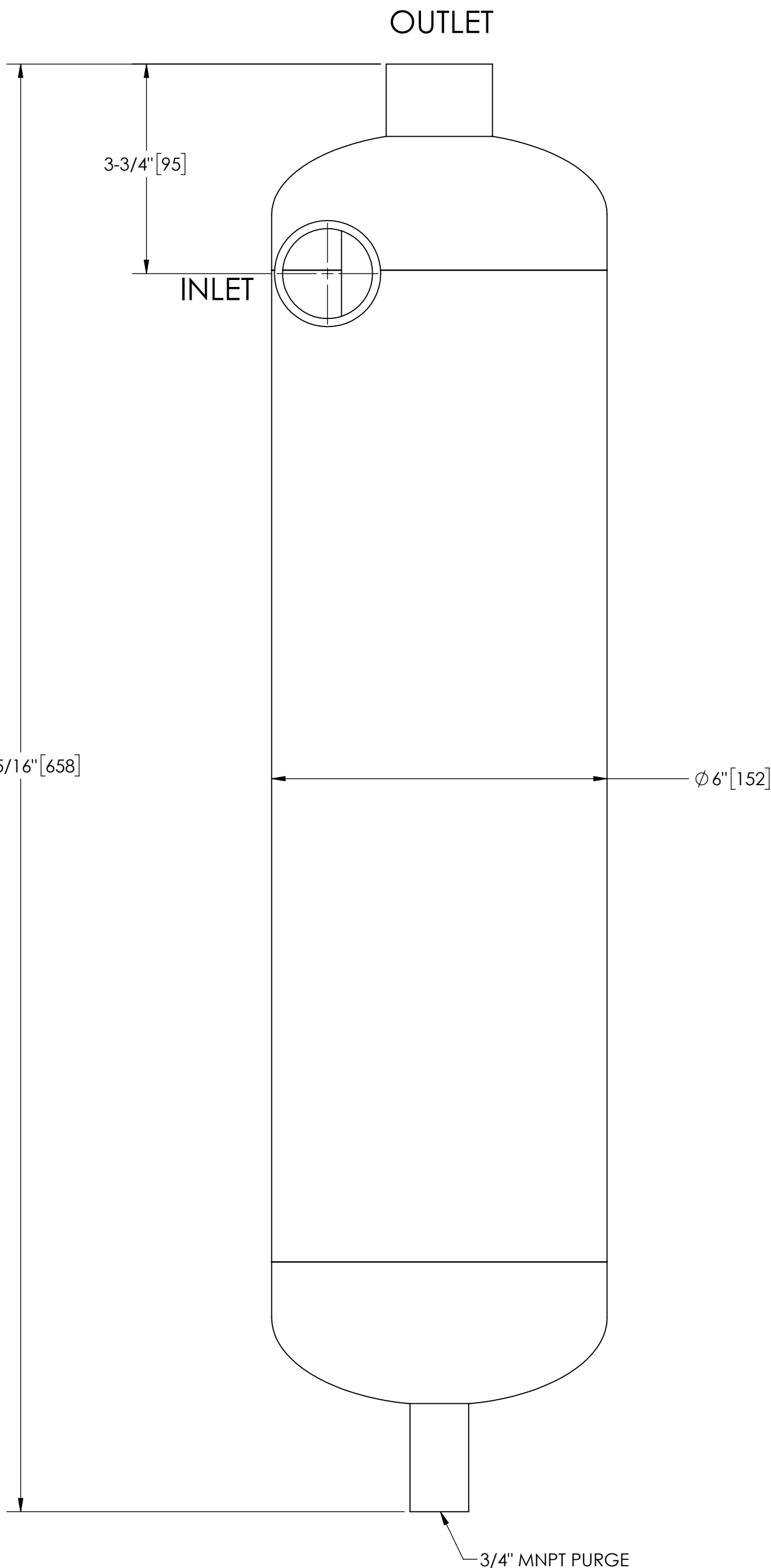

SUBMITTAL DRAWING

This drawing is submitted for spatial consideration only. Do not pre-plumb to these dimensions.

UNLESS OTHERWISE SPECIFIED: DIMENSIONS ARE IN: INCHES [mm] TOLERANCES ARE: FRACTIONS DECIMALS ANGLES ± 1" .XX ± .01 ± 1/4° .XXX ± .005 .XXXX ± .0005			ENGINEERED FOR: STANDARD		 FRESNO, CALIFORNIA WWW.LAKOS.COM	
DO NOT SCALE DRAWING			APPROVALS	DATE	TITLE	
MATERIAL: TYPE 304L STAINLESS STEEL			DRAWN: MQ	4/5/12	SMP-45, SEPARATOR 45-70 gpm, 304L STAINLESS STEEL	
FINISH: POLISH			ENGR: -	-	SIZE: C	MODEL NO.
			REVIEW: -	-	SCALE: 1:4	DWG NO. 114794
			WORK ORDER	QTY.	EST. WT. 14 lb	SHEET 1 OF 1

DWG NO. 114794
SHEET 1
REV. C