

4

3

2

1

EXCEPT AS OTHERWISE PROVIDED BY CONTRACT, THIS DRAWING AND SPECIFICATIONS SHALL NOT BE REPRODUCED, COPIED OR USED AS THE BASIS FOR MANUFACTURE OR SALE OF MATTER DEPICTED HEREIN WITHOUT THE EXPRESSED WRITTEN PERMISSION OF THE LAKOS CORPORATION, OR ITS ASSIGNEES.

THIS DRAWING HAS BEEN GENERATED AND IS MAINTAINED BY A CAD SYSTEM. CHANGES SHALL ONLY BE INCORPORATED AS DIRECTED BY AN APPROVED ENGINEERING CHANGE ORDER (ECO). PAPER COPIES ARE UNCONTROLLED.

REVISIONS				
ECN	REV.	DESCRIPTION	DATE	APPROVED
	C	RELEASED FOR SUBMITTAL	5/21/20	AMF

NOTES:

1. INLET & OUTLET ARE 1-1/4" MNPT PIPE.
2. MAXIMUM PRESSURE: 100 psi (6.9 bar).
3. MAXIMUM TEMPERATURE: 120°F (49°C).
4. PRESSURE LOSS: 3-12 psid (.2-.8 bar) AT RATED FLOW.
5. RATED FLOW: 30-48 gpm (114-182 m³/hr).
6. APPROXIMATE DRY WEIGHT: 14 lbs (6 kg).
7. FINISH: POLISH (EXTERIOR ONLY).

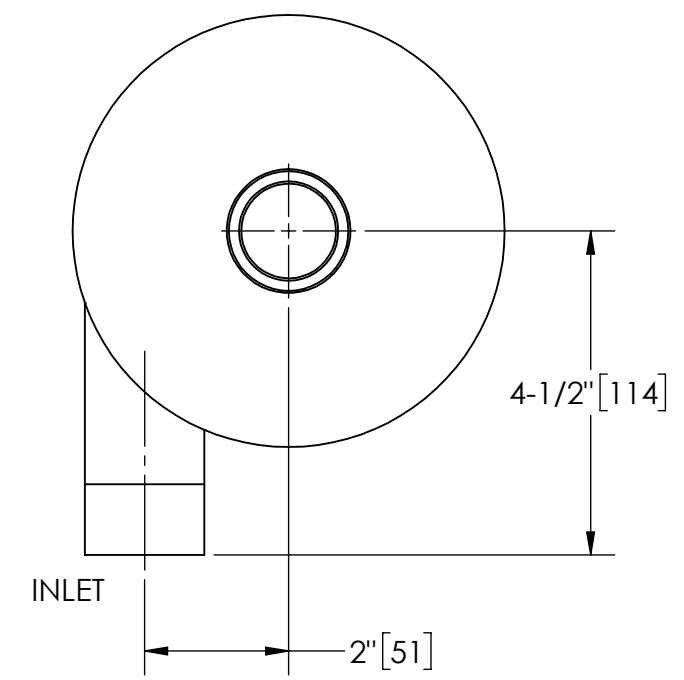
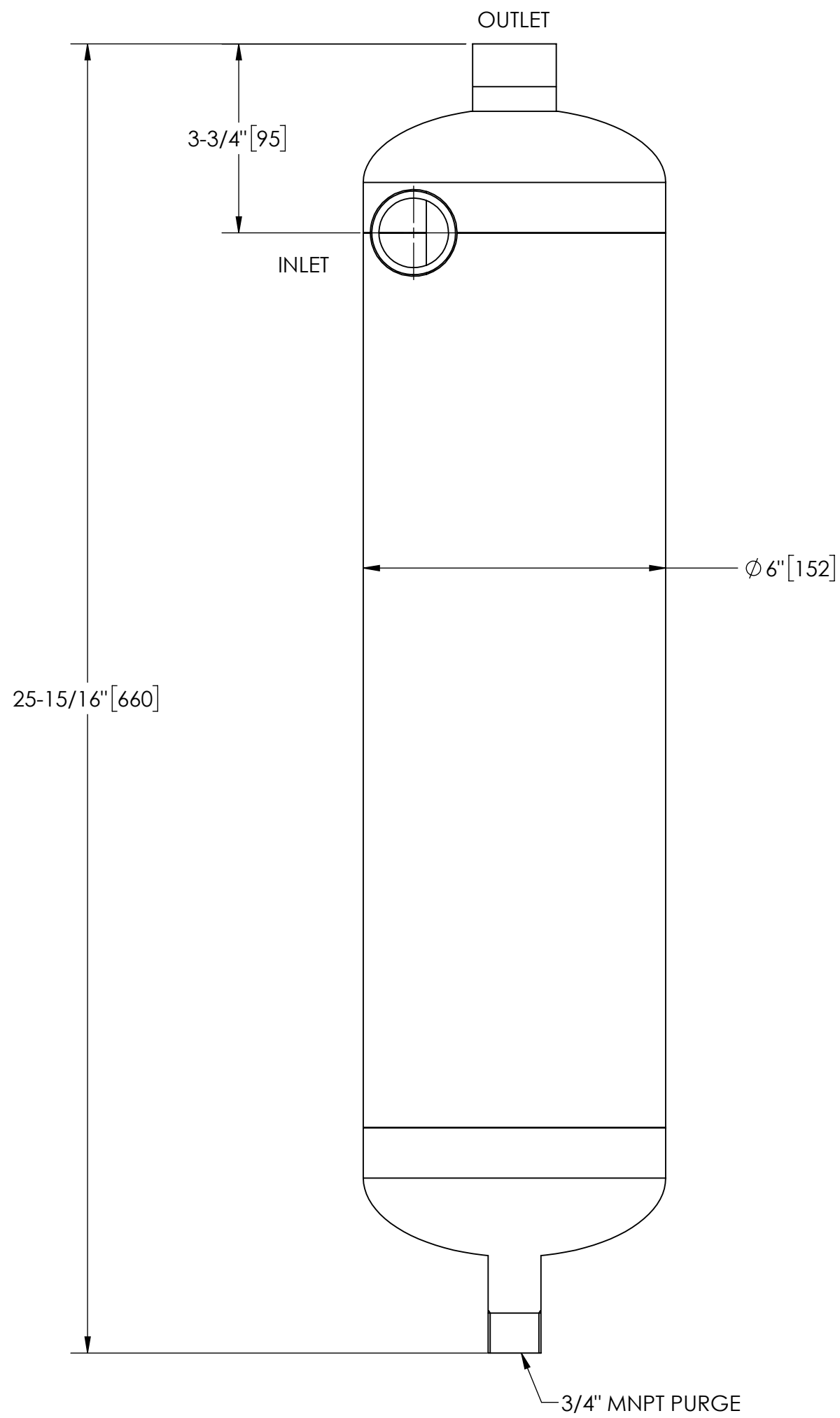

TOP VIEW

SUBMITTAL DRAWING

This drawing is submitted for spatial consideration only. Do not pre-plumb to these dimensions.

UNLESS OTHERWISE SPECIFIED: DIMENSIONS ARE IN: INCHES (mm) TOLERANCES ARE: FRACTIONS    DECIMALS    ANGLES ± 1/2"    .XX ± .01    ± 1/4° .XXX ± .005 .XXXX ± .0005			ENGINEERED FOR: <b>STANDARD</b>			
DO NOT SCALE DRAWING			APPROVALS	DATE	TITLE	
MATERIAL: TYPE 304L STAINLESS STEEL			DRAWN: MQ	4/5/12	SMP-30, SEPARATOR	
FINISH: POLISH			ENGR: -	-	30-48 gpm, 304L STAINLESS STEEL	
			REVIEW: TPF	5/22/20	SIZE: C	MODEL NO.
			WORK ORDER	QTY.	SCALE: 3:8	DWG NO. 114793
						EST. WT. 14 lb
						SHEET 1 OF 1

4

3

2

1

DWG. NO. 114793  
SHEET 11  
REV. C