

EXCEPT AS OTHERWISE PROVIDED BY CONTRACT, THIS DRAWING AND SPECIFICATIONS SHALL NOT BE REPRODUCED, COPIED OR USED AS THE BASIS FOR MANUFACTURE OR SALE OF MATTER DEPICTED HEREIN WITHOUT THE EXPRESSED WRITTEN PERMISSION OF THE CLAUDE LAVAL CORPORATION, OR ITS ASSIGNEES.

NOTES:

1. INLET & OUTLET FLANGES ARE 12" 150# RF PER ANSI B16.5 REQUIRING 12X $\phi 7/8$ " BOLTS (BOLTS AND GASKETS NOT INCLUDED).
2. MAXIMUM PRESSURE: 150 psi (10.3 bar).
3. MAXIMUM TEMPERATURE: 180°F (82.2°C).
4. PRESSURE LOSS: 3-12 psid (.2-.8 bar) AT RATED FLOW.
5. RATED FLOW: 2650-4900 gpm (600-1115 m³/hr).
6. APPROXIMATE DRY WEIGHT: 3315 lbs (1504 kg).
7. FINISH: LAKOS BLUE (EXTERIOR ONLY).

REVISION HISTORY				
ZONE	REV	DESCRIPTION	DATE	APPROVED

THIS DRAWING HAS BEEN GENERATED AND IS MAINTAINED BY A CAD SYSTEM. CHANGES SHALL ONLY BE INCORPORATED AS DIRECTED BY AN APPROVED ENGINEERING CHANGE ORDER (ECO). PAPER COPIES ARE UNCONTROLLED.

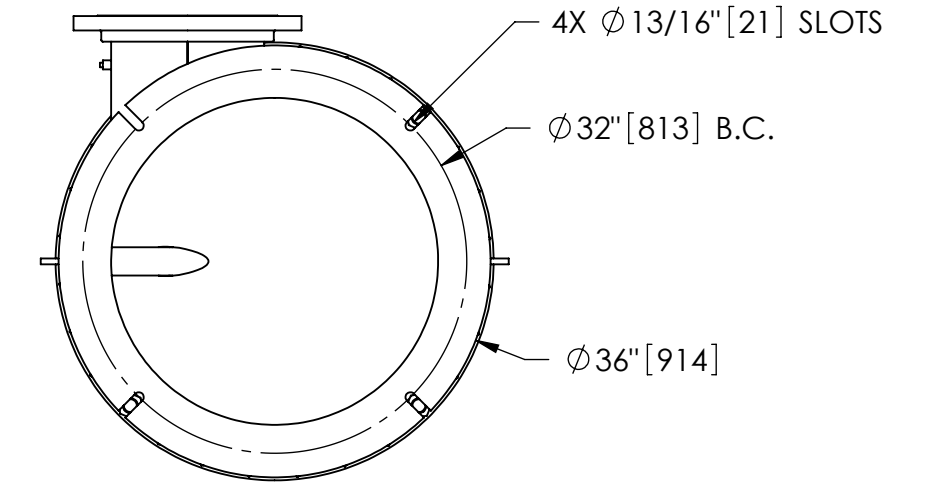
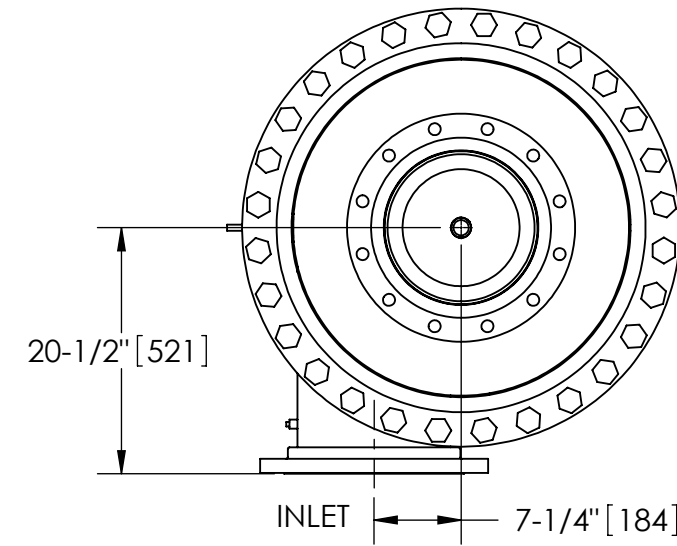

BOTTOM VIEW

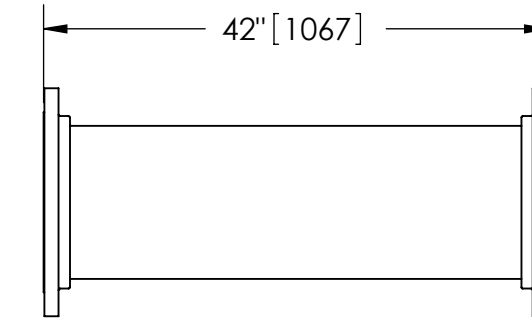

FLANGED SPOOL
MODEL FS-T2 (AVAILABLE SEPARATELY)
REQUIRED FOR REMOVAL OF TOP ASSEMBLY

SUBMITTAL DRAWING

This drawing is submitted for spatial consideration only. Do not pre-plumb to these dimensions.

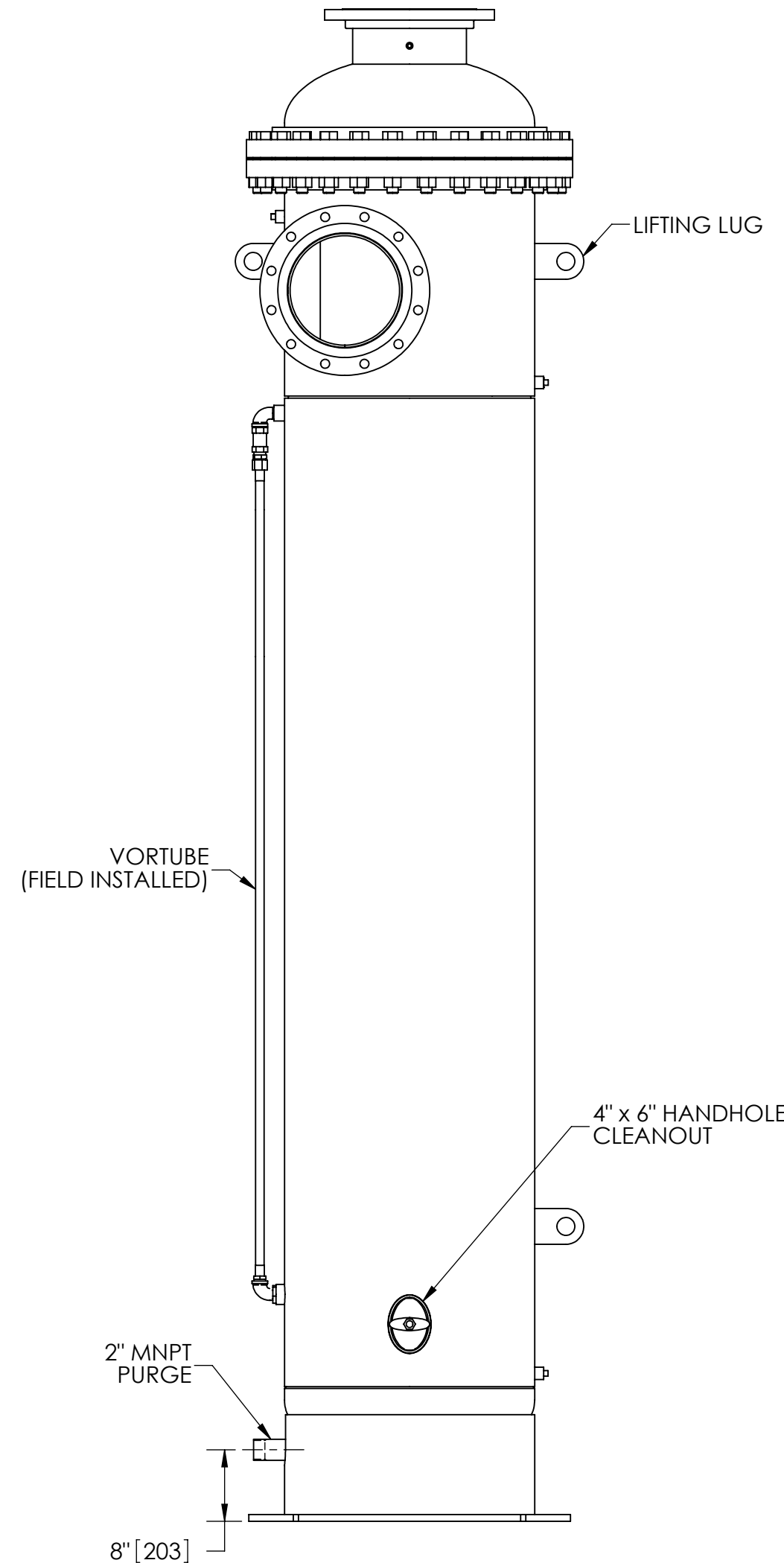
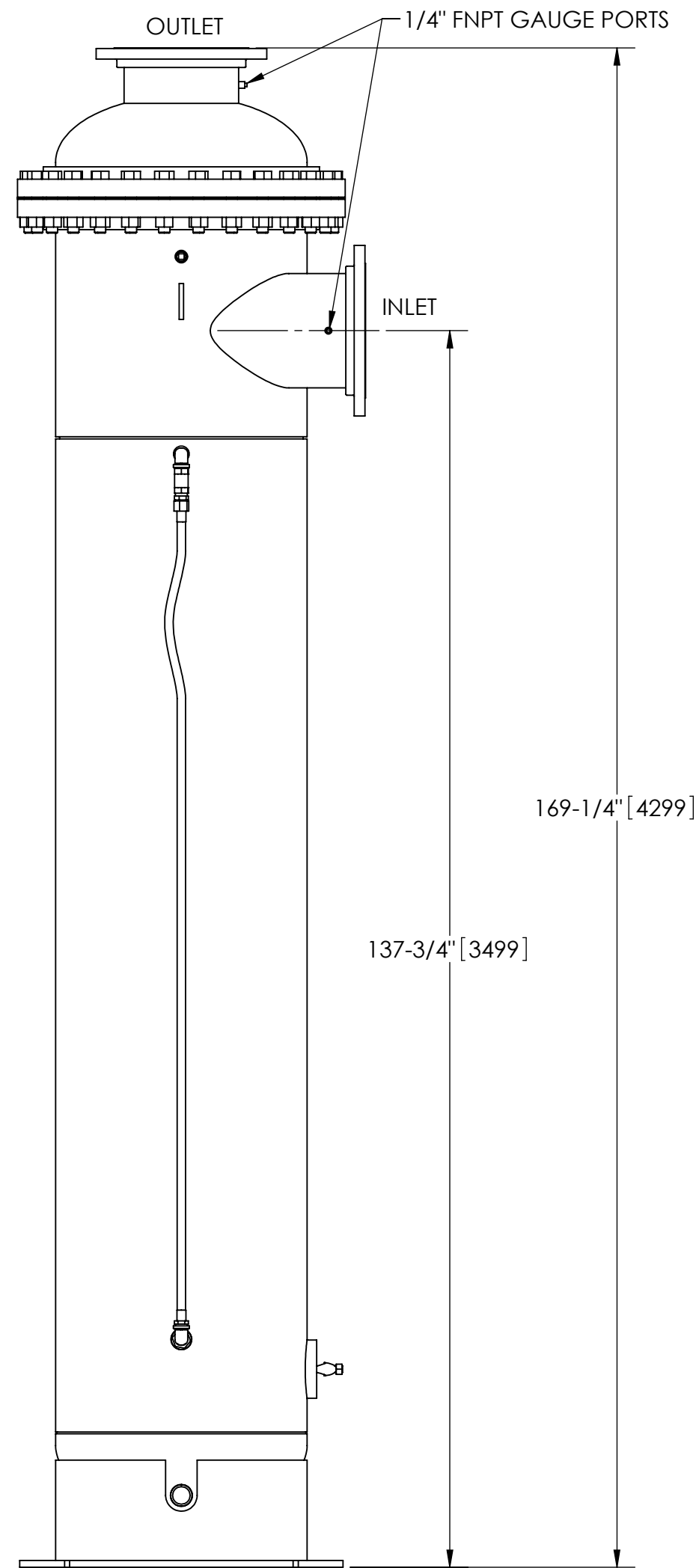

UNLESS OTHERWISE SPECIFIED: DIMENSIONS ARE IN: INCHES [mm] TOLERANCES ARE: FRACTIONS .XX ± .01 ANGLES ± 1/4° DECIMALS .XXX ± .005 MILS .XXX ± .0005		ENGINEERED FOR: FLANGED		CLAUDE LAVAL CORP. FRESNO, CALIFORNIA 93727 WWW.LAKOS.COM		LAVAL UNDERGROUND SURVEYS				
DO NOT SCALE DRAWING		APPROVALS	DATE	TITLE						
MATERIAL	CLASS P-1 MILD CARBON STEEL	DRAWN	DLW	4/4/06	JPX-2650-V/FLG, SEPERATOR, 2650-4900 gpm, CARBON STEEL					
FINISH	LAKOS BLUE	ENGR	JBI	4/2/08	SIZE	MODEL NO.	DWG NO.	REV.		
		WORK ORDER			C		124877	C		
					SCALE	1:16	EST. WT.	3315 lb	SHEET	1 OF 1

DWG NO.

124877

SHEET

REV. C

A