

EXCEPT AS OTHERWISE PROVIDED BY CONTRACT, THIS DRAWING AND SPECIFICATIONS SHALL NOT BE REPRODUCED, COPIED OR USED AS THE BASIS FOR MANUFACTURE OR SALE OF MATTER DEPICTED HEREIN WITHOUT THE EXPRESSED WRITTEN PERMISSION OF THE LAKOS CORPORATION, OR ITS ASSIGNEES.

THIS DRAWING HAS BEEN GENERATED AND IS MAINTAINED BY A CAD SYSTEM. CHANGES SHALL ONLY BE INCORPORATED AS DIRECTED BY AN APPROVED ENGINEERING CHANGE ORDER (ECO). PAPER COPIES ARE UNCONTROLLED.

REVISIONS				
ECN	REV.	DESCRIPTION	DATE	APPROVED
	01	RELEASED FOR SUBMITTAL	4/14/21	TPF

NOTES:

1. INLET IS 3" PIPE (125# ANSI FLANGED).
2. OUTLET IS 2" PIPE (150# ANSI FLANGED).
3. PURGE OUTLET IS 3/4" PIPE.
4. MAXIMUM PRESSURE: 150 psi (10.3 bar).
5. MAXIMUM FLUID TEMPERATURE: 100°F (37.8°C).
6. SPECIFIED FLOWRATES:
BASIN SWEEPING - 110 gpm (25 m³/hr)
SIDE STREAM & CLOSED LOOP - 140 gpm (32 m³/hr).
7. FINISH: AS ASSEMBLED.
8. POWER REQUIREMENT: 3/60/460V.
9. NEMA 4X MOTOR STARTER ENCLOSURE WITH SAFETY DISCONNECT AND H.O.A. SWITCH.
10. APPROXIMATE DRY WEIGHT: 766 lbs (347 kg).
11. INLET/OUTLET VALVE KIT RECOMMENDED: SEE FACTORY.
12. MINIMUM PIPE FROM TOWER BASIN TO JC SYSTEM IS 3" PIPE.
13. FLOODED SUCTION REQUIRED.

COMPONENT LIST:

- 1 ELECTRICAL CONTROL BOX 3/60/460V, 60Hz W/120V TRANSFORMER.
- 2 SEPARATOR: eJPX-0080-V.
- 3 PUMP: 3 HP CENTRIFUGAL, 1800 rpm, 3/60/460V.
- 4 INLET/OUTLET PRESSURE GAUGES: 0-160 psi, GLYCERIN-FILLED.
- 5 PURGE EQUIPMENT: SRV-833.
- 6 DIFFERENTIAL PRESSURE INDICATOR: (AVAILABLE WITH DRY ELECTRICAL CONTACT - MODEL DHE-15-S. ORDER SEPARATELY).
- 7 STRAINER, SUCTION DIFFUSER.

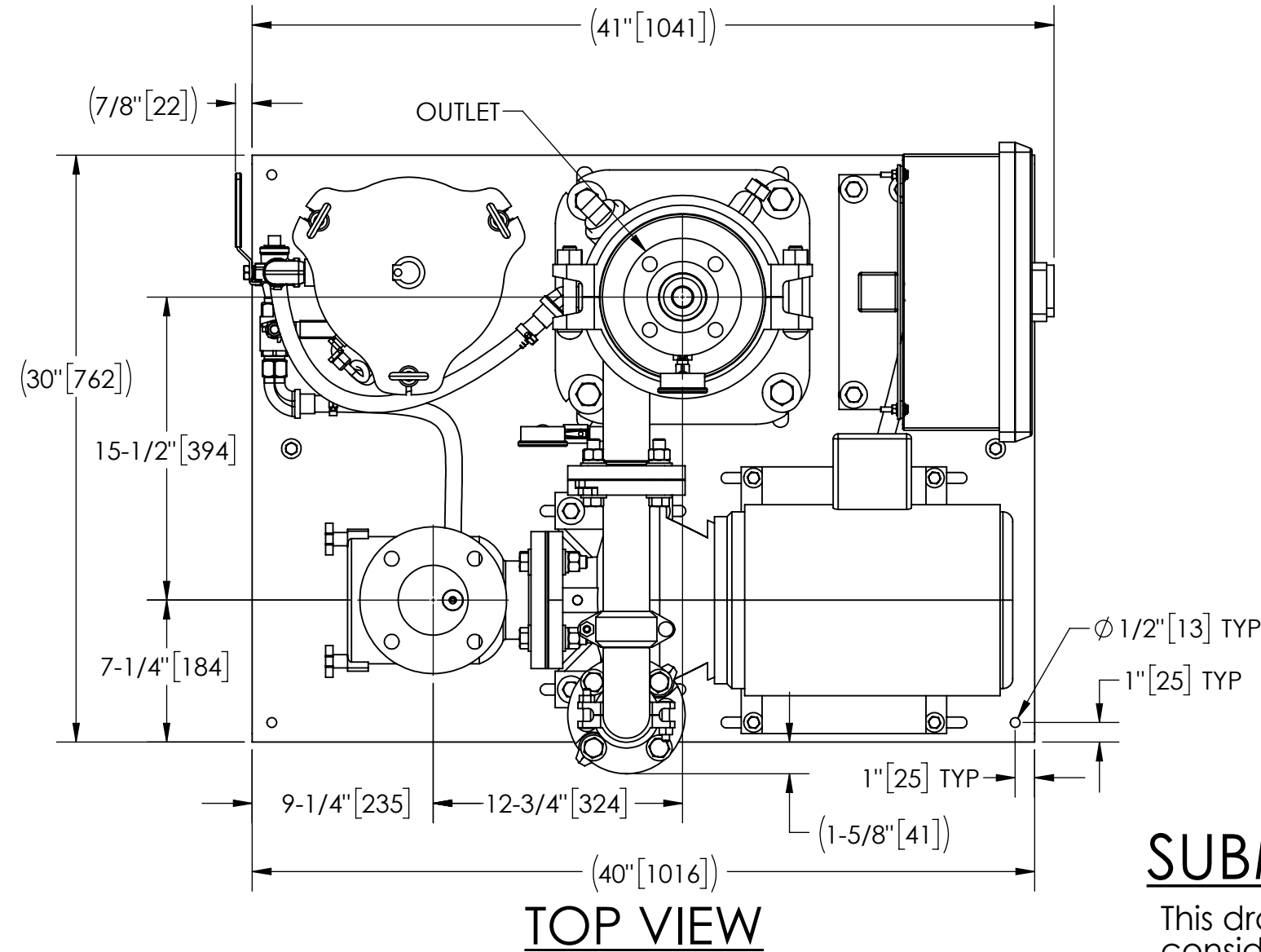

SUBMITTAL DRAWING

This drawing is submitted for spatial consideration only. Do not pre-plumb to these dimensions.

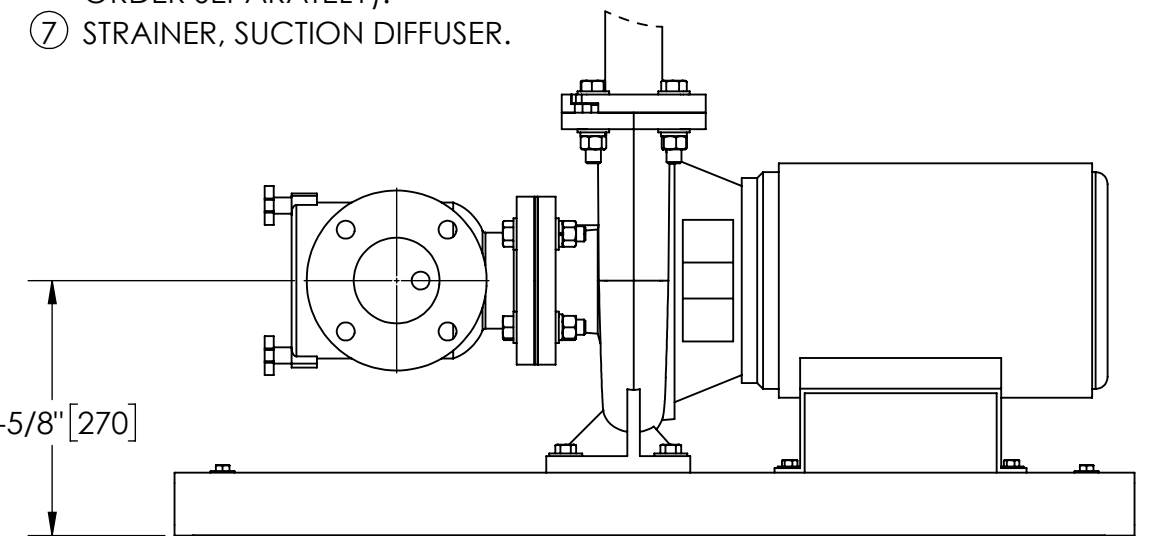

FRONT VIEW WITH ROTATED STRAINER (OPTIONAL)

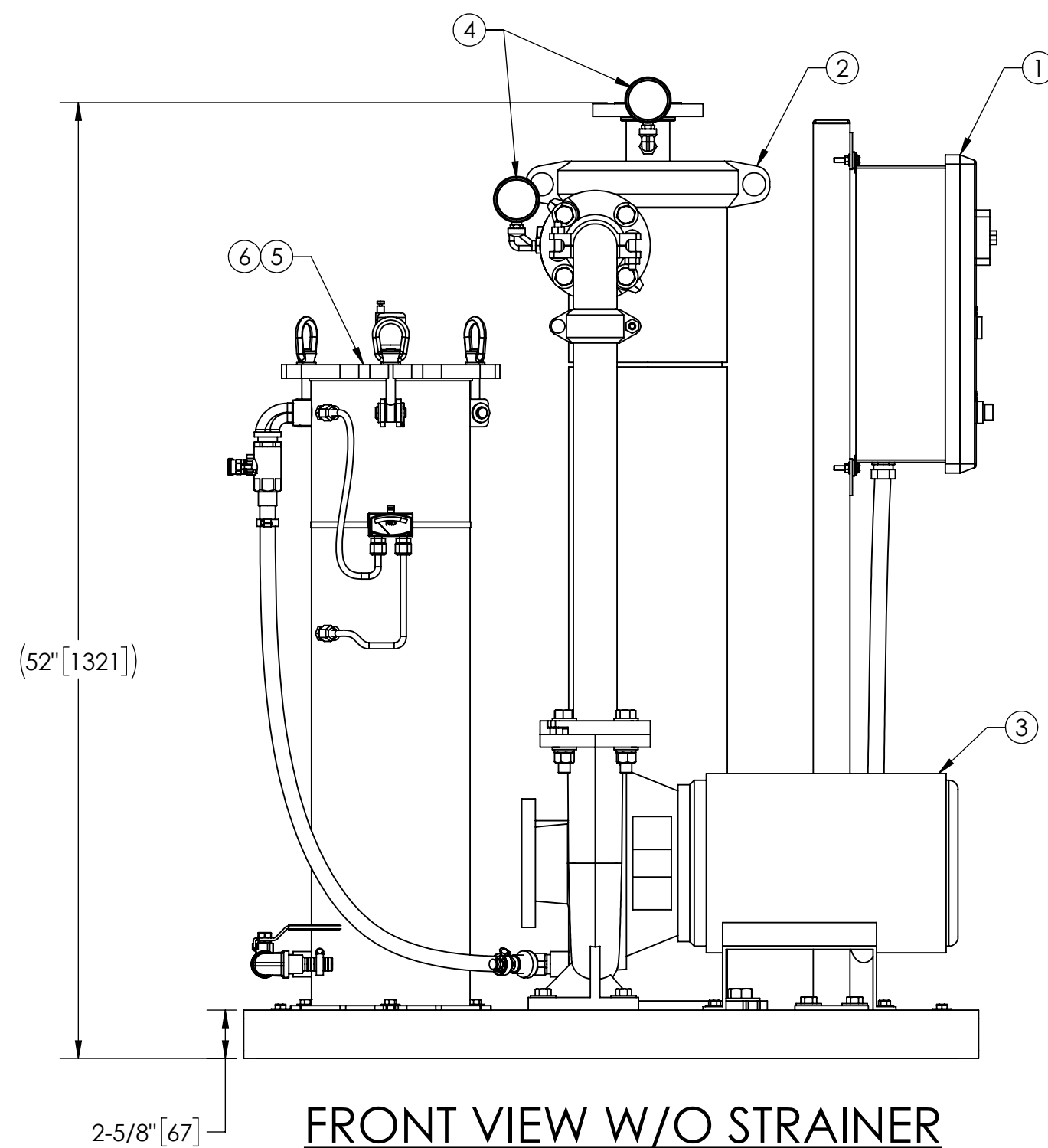
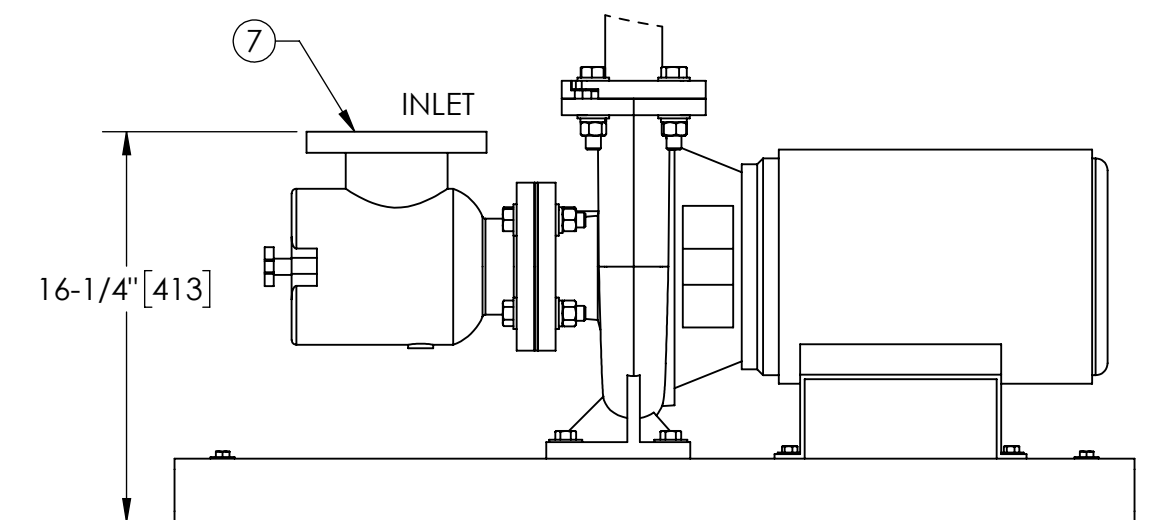

UNLESS OTHERWISE SPECIFIED: DIMENSIONS ARE IN: INCHES [mm]		ENGINEERED FOR:			
TOLERANCES ARE:		STANDARD			
FRACTIONS ± 1"	DECIMALS .XX ± .01 .XXX ± .005 .XXXX ± .0005	ANGLES ± 1/4°	APPROVALS	DATE	TITLE
DO NOT SCALE DRAWING			DRAWN TPF	4/14/21	eJCX-0110-SRV, JC SYSTEM HI EFF SWEEPER eJPX-0080, 3/60/460V
MATERIAL PER LAKOS SPEC.			ENGR -	-	
FINISH AS ASSEMBLED			REVIEW -	-	SIZE C
			WORK ORDER	QTY.	MODEL NO.
					DWG NO. 185237
					REV. 01
					SCALE 1:8
					EST. WT. 766 lb
					SHEET 1 OF 1

DWG NO. 185237
SHEET 1 OF 1
REV. 01